

Modular Units - Planning Information:

The Modular Unit is designed to provide a personalised storage system in the kitchen space that can be fashioned to suit each individual customer. By selecting from the wide range of internal fittings, the designer has the opportunity to create individual styles. Whilst some parts are interchangeable, certain internal fitment filler kits must be used in order for the cabinets to operate correctly. The following pages feature key planning notes for each internal fitment to help the designer when planning. We have also illustrated two modular unit fits that feature all internal fitments to provide understanding of how to fit each fitment into the unit.

The Modular Unit - Features & Benefits:

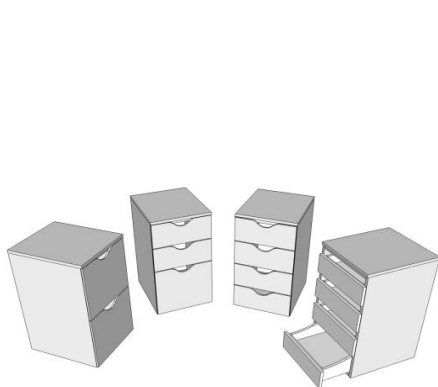

The modular unit can be personalised with a range of **x4 different** drawer styles.

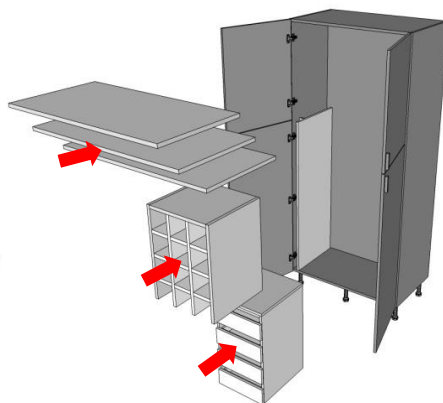

The **flatpack larder** features x6 shelves that can be fully removed to create a blank cabinet, ready for fitting the internal fittings.

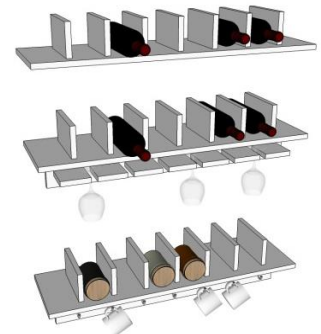

The shelves within this unit can be changed for the wine rack shelf. The wine rack shelf

Generic Product Specification - Modular Units - Divider Packs

Important Information: There are two divider pack sizes available to suit both single modular units (400, 500 & 600mm wide) & double modular units (800, 1000 & 1200mm wide).

MASTERCLASS®
KITCHENS

Modular Units - Planning Information:

The shelves supplied with the modular unit can be removed or unused if supplied flat packed. This creates an empty cabinet for the fitter to insert internal fittings. If the designer plans a modular unit to feature drawer boxes, they **MUST** plan for the divider pack to be installed next to the units internal side cheek. The divider packs performs by purposely spacing the drawer pack away from the units hinges. Drawer boxes CANNOT operate when placed directly next to the hinges.



800, 1000 & 1200mm wide modular unit housings are supplied flat packed due to the overall size. The shelving supplied with this larder can be removed to allow installation of internal fittings.

400, 500 & 600mm
Modular units

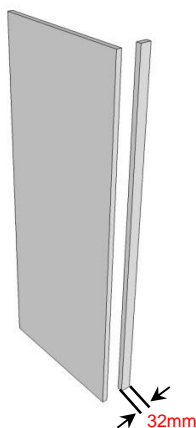

800, 1000 & 1200mm
Modular units

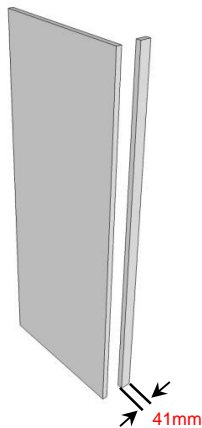

The spacers are supplied in two sizes - the full depth panel is 498 D x 1224 H x 18mm thick. The smaller spacer piece is supplied at either 32mm or 41mm wide, depending on the modular unit ordered.

The pre drilled holes for this set serve no purpose. The tall panel is an identical component to the tall panel used in the division set.

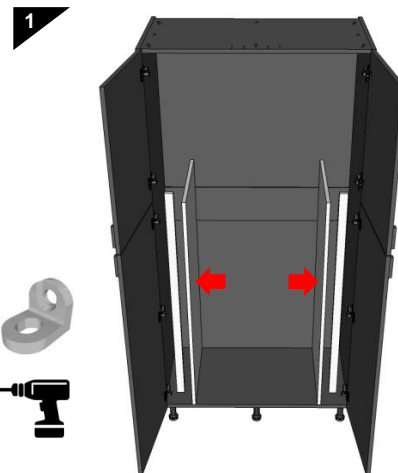

Insert divider pack into cabinet housing:

- Begin by inserting the smaller section against the side cheek & fix with L tags & Hilo screws BEHIND spacer.
- Place the full depth spacer next to the smaller spacer & fix.

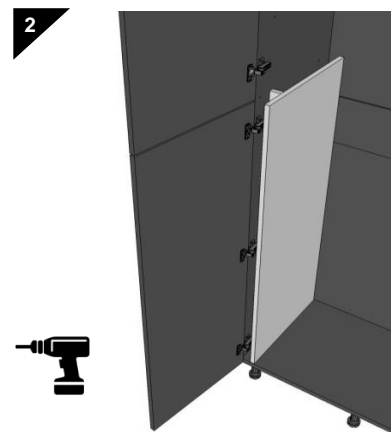

Fix the full depth panel to the smaller spacer:

- Fix the full depth panel to the smaller spacer with Hilo screws.

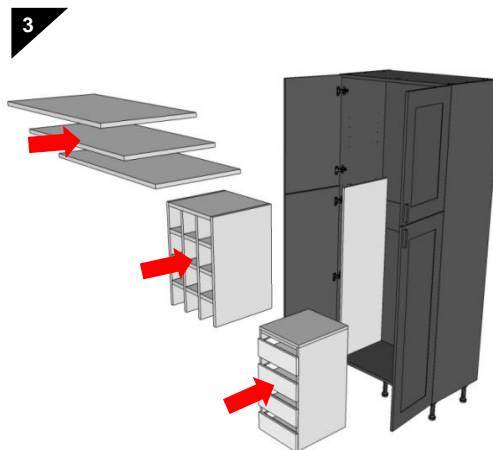

Begin to fill the modular unit:

- Further internal fittings can be fitted when all dividers have been fitted.

Generic Product Specification - Modular Units - 150mm Box Wine Rack & Centre Spacer

Important Information: The 150mm Box Wine Rack **CANNOT** be used in the 400mm or 800mm wide modular unit.

Modular Units - Planning Information:

The 150mm box wine rack has been designed to perform similar to the divider pack by creating a purpose void between the cabinets hinges & its internal fitments. Unlike the divider pack, the box wine rack is **ONLY** available in one size. The 150mm Box Wine Rack is supplied with a 36mm wide spacer. This spacer is required when fitting inside a 1000 or 1200mm wide modular unit. It is unnecessary for the 500 & 600mm wide modular units.

500 & 600mm Modular units:

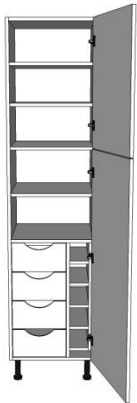

x1

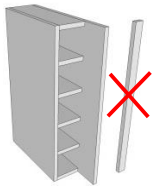

1000 & 1200mm Modular units:

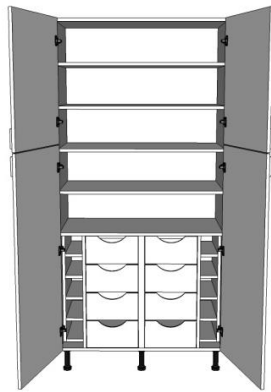

x2

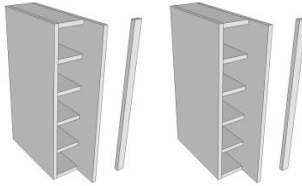

1000 & 1200mm Modular unit - Using the spacer:

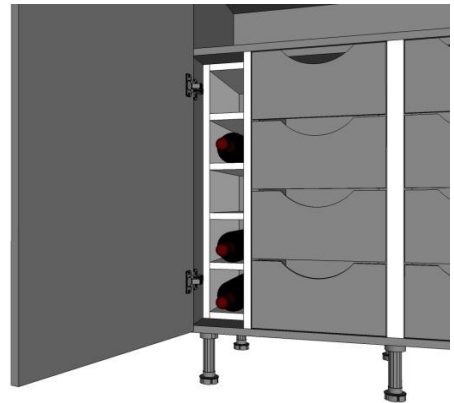

The spacer is positioned in between the drawer boxes.

The second spacer for the second 150mm Box Wine Rack can be positioned towards the back of the drawer boxes for support.

Refer to the following fit for guidance:

1

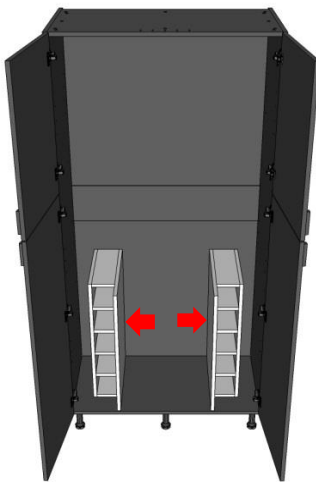

Insert the 150mm box wine racks into the cabinet housing:

- Begin by inserting the 150mm box wine racks inside the cabinet.

2

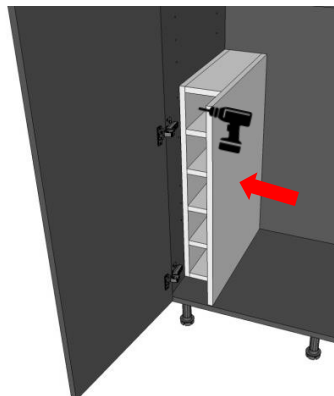

Place the 150mm box wine rack against the side of the cabinet's side cheek & fix:

- Fix with screws from within the box wine rack.

3

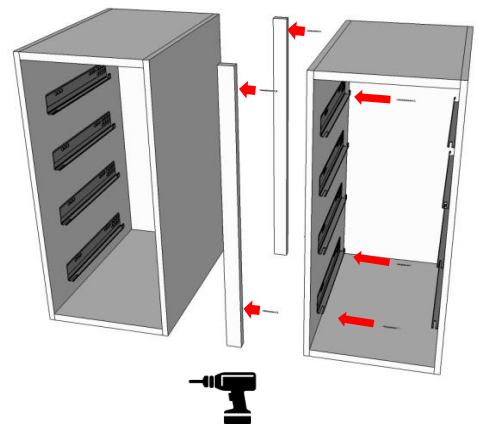

Fix the x2 drawer boxes to the x2 spacers:

- Remove the drawers to make fitting easier. Screw the two spacers as shown - one at the front & one at the back of the cabinets.

Generic Product Specification - Modular Units - 150mm Box Wine Rack & Centre Spacer

Important Information: The 150mm Box Wine Rack CANNOT be used in the 400mm or 800mm wide modular unit.

MASTERCLASS®
KITCHENS

Modular Units - Planning Information:

4

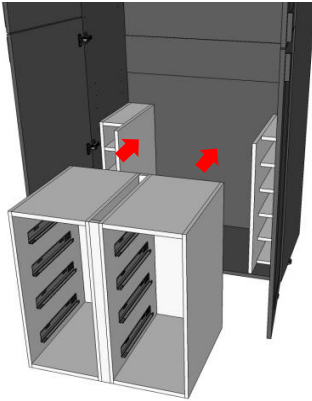

Insert assembled drawer boxes into cabinet housing:

- Insert the assembled drawer boxes with spacers fixed into the modular unit.

5

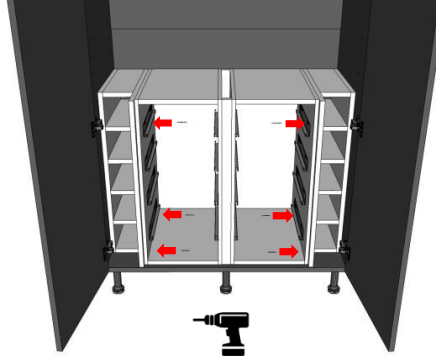

Fix to the 150mm box wine racks:

- Fix the assembled drawer boxes into the 150mm Box Wine Rack sides.

6

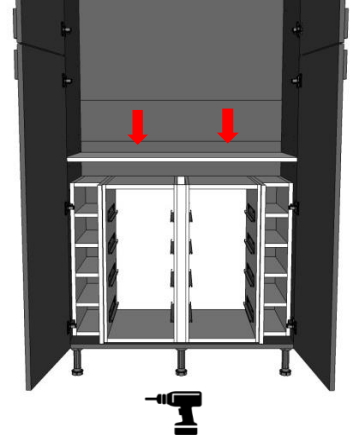

Fix full depth shelf to the drawer boxes & 150mm box wine racks from the underside:

- Place the full depth shelf supplied with the cabinet on top of the drawer boxes & 150mm Box Wine Racks.
- Screw from under the drawer boxes & 150mm Box Wine Racks through into the shelf, securing into position.

7

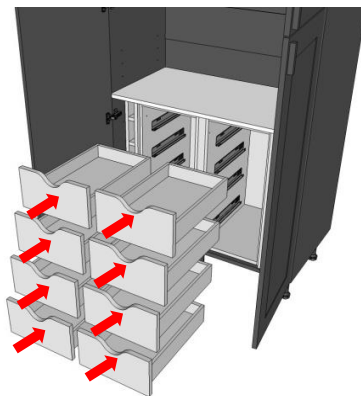

Reinsert the drawers into the drawer boxes:

- With the drawer boxes now fitted, the fitter can reinsert the drawers into the drawer boxes.

Tip:

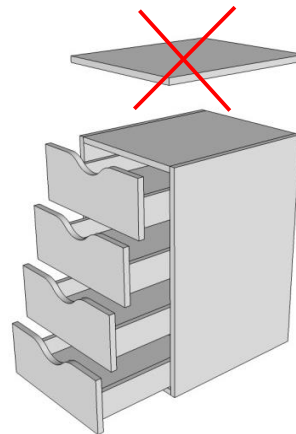

When using 150mm Box Wine Racks with the drawer boxes in the 1000 & 1200mm version of the modular unit, the supplied top shelf is NOT required. The fitter must use the full depth shelf supplied to 'cover' all four fitments.

Important Information: Centre panel should be rotated horizontally, **NOT** vertically in order to align with shelf holes.

Modular Units - Planning Information:

The Half Loose Shelves & Division Set consists of a central full depth panel & x3 half width shelves - widths vary dependant on cabinet size selected. This set is designed to be positioned in the centre of the housing, performing as a central support for the entire housing. The fitter can position this set either side inside the modular unit. **Note:** This set can **ONLY** be used within a 800, 1000 or 1200mm wide modular unit.

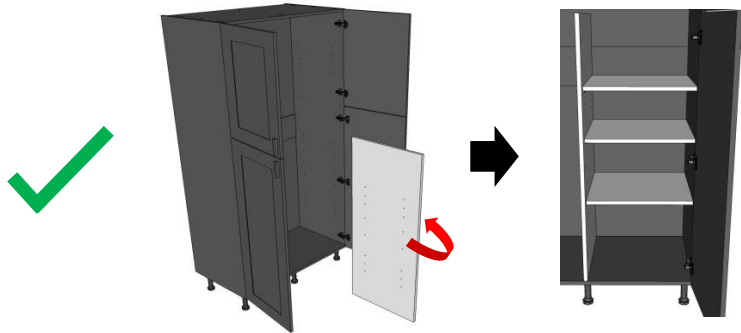

Turning the Tall Panel **HORIZONTALLY** enables the shelf holes to align with the cabinets shelf holes.

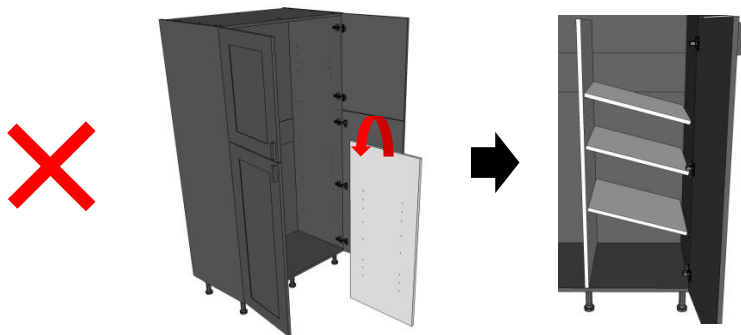

Turning the Tall Panel **VERTICALLY** will cause the shelf holes to miss the cabinets shelf holes. This will be the result.

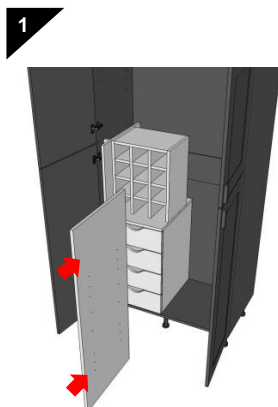
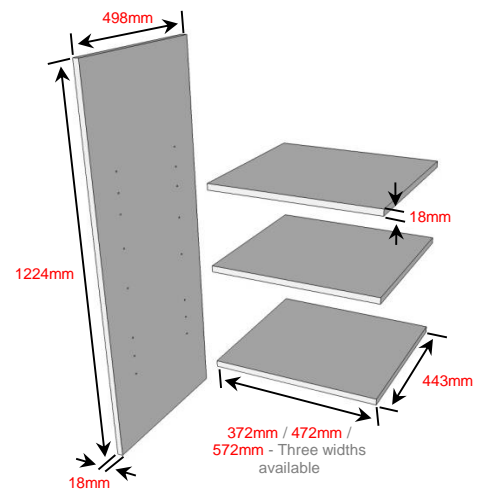

Insert the full depth panel:

- When positioning the central tall panel, ensure the all other internal fitments are already fitted. This will make the fit easier.

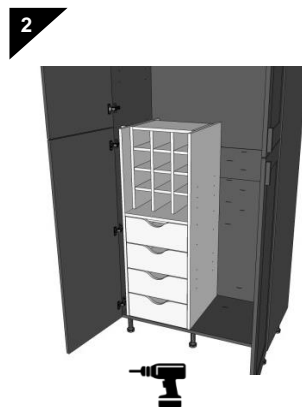

Fix into place:

- Screw through the drawer box & box wine rack into the panel.

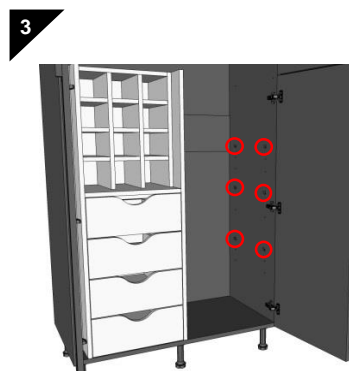

Insert shelf pegs into place:

- Insert shelf pegs into both the cabinet side cheek & central division panel.
- Use the Clear shelf pegs for these shelves:

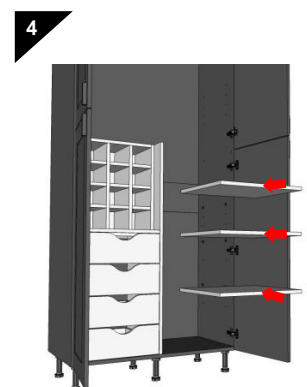

Insert shelving into cabinet housing:

- Place the shelves onto the shelf pegs.

Generic Product Specification - Modular Units - Drawer Boxes

Important Information: drawer boxes supplied fully assembled.

MASTERCLASS®
KITCHENS

Modular Units - Planning Information:

The modular unit can be fitted with x4 different styles of drawer boxes.
The drawer boxes are available in three different widths to suit all modular unit sizes. Refer to your product manual for further information on what drawer box suits each modular unit.

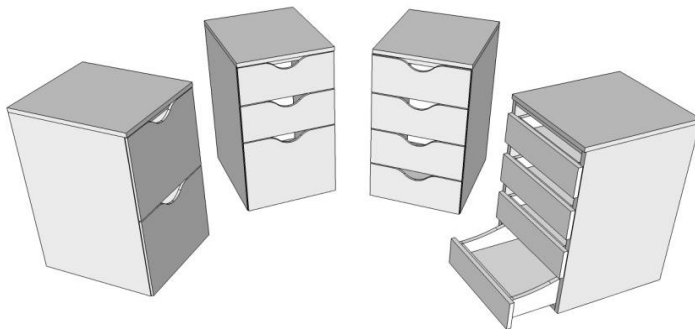

- x2 Pan drawers
- x2 Standard & x1 Pan drawers
- x4 Standard drawers
- x4 Vegetable drawers

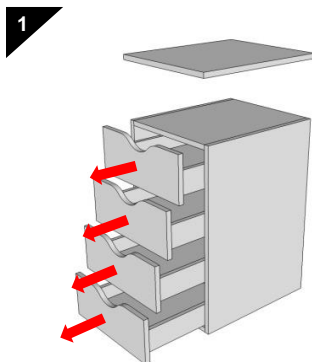
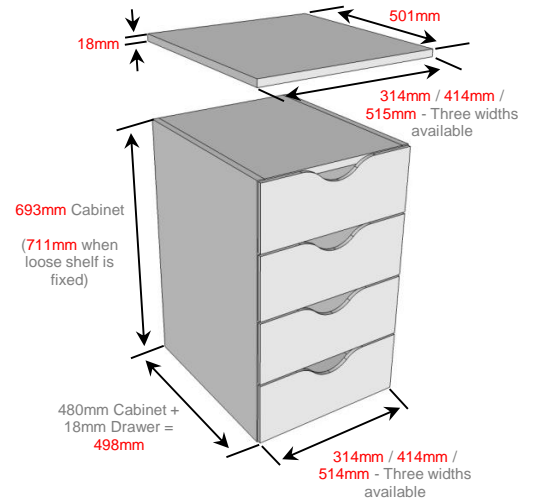

Remove the drawers from the cabinet:

- Place hands under each drawer & pull Movento runner mech to release drawer.

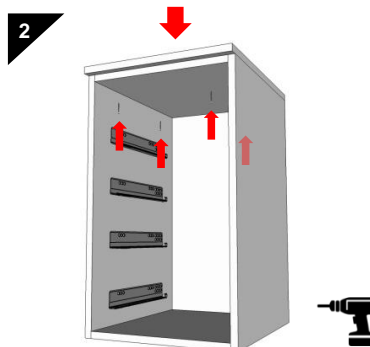

Fix top shelf with screws:

- Position the shelf so the front is overlaying the cabinet frontage - the back of the shelf should be flush with the back of the cabinet.

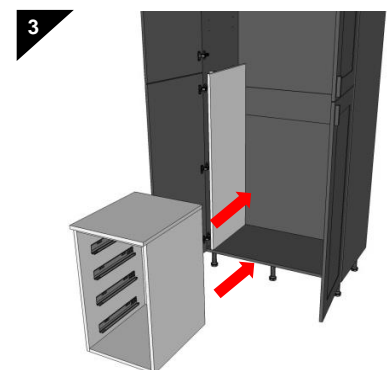

Insert drawer box into the larger housing:

- Position the drawer box next to the divider or 150mm wine rack (depending on unit configuration).

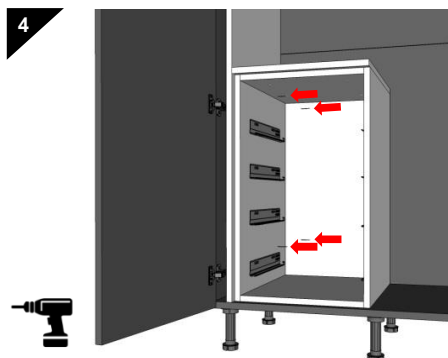

Fix the drawer box into the divider / 150 wine rack:

- Fix from within the drawer box cabinet.

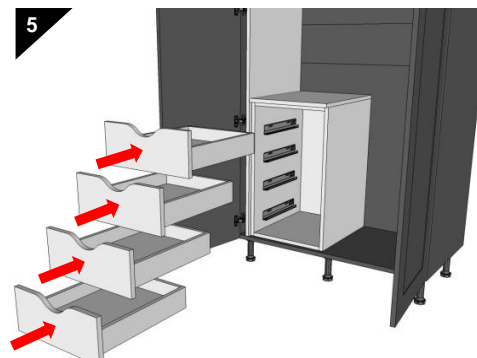

Insert drawers back into the drawer box once fixed:

- Reinsert the drawers back into the drawer box. The

Generic Product Specification - Modular Units - Box Wine Racks

Important Information: The wine rack is purposely set back from the cabinet housing by 100mm for the bottle necks to be exposed.

Modular Units - Planning Information:

The box wine racks have been designed to be positioned on top of the drawer boxes. These racks are identical in unit width as the drawer boxes for a clean vertical run. The box wine rack **MUST** be flush with the smaller spacer (part of the divider pack). Refer to the following for all versions of these racks.

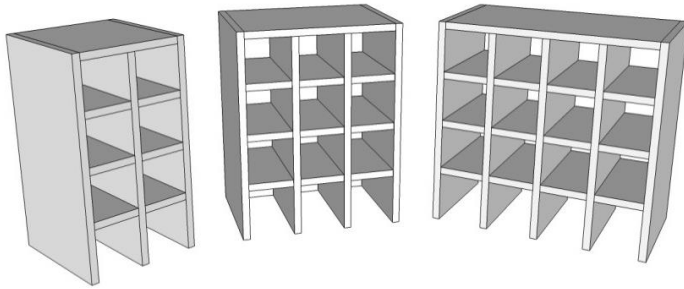

- 8 bottle box wine rack - 314mm wide version
- 12 bottle box wine rack - 414mm wide version
- 16 bottle box wine rack - 514mm wide version

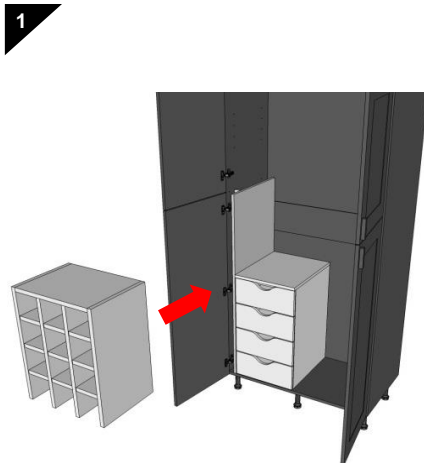
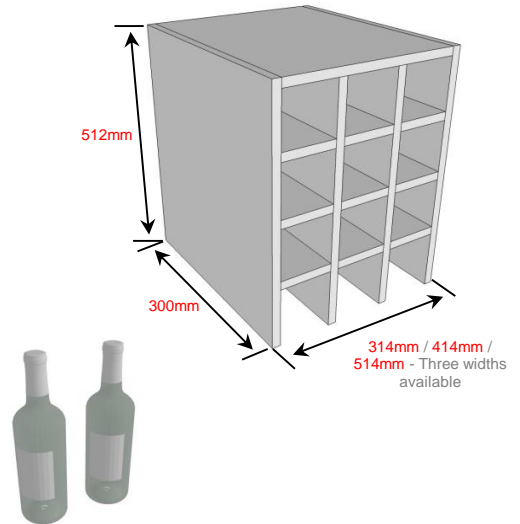

Insert the box wine rack on top of the drawer box:

- Position the box wine rack on top of the drawer box. Wine racks should be positioned on drawer boxes.

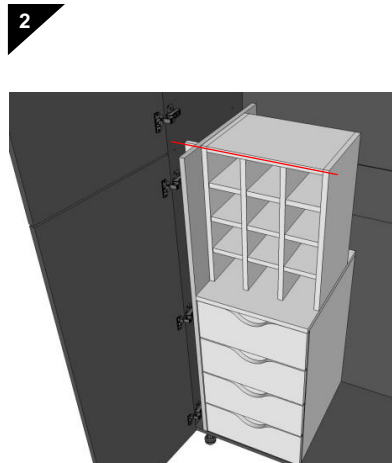

Ensure front of box wine rack is aligned with smaller spacer on divider set:

- All box wine racks should be aligned with the positioning of the smaller spacer.

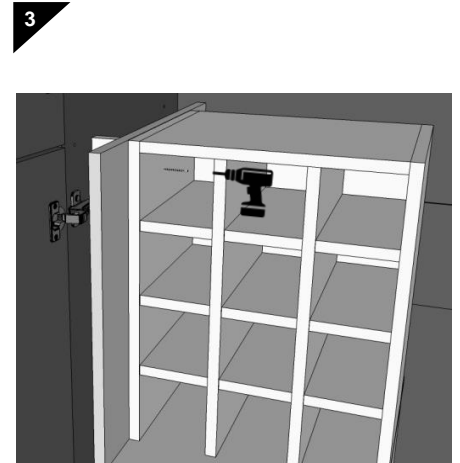

Fix the box wine rack into the divider set:

- Fix through divider panel into the spacer fixed into cabinet side cheek.

Generic Product Specification - Modular Units - x2 standard reduced depth drawer with wine rack

Important Information: drawer boxes supplied fully assembled.

MASTERCLASS®
KITCHENS

Modular Units - Planning Information:

The x2 drawer box with wine rack shelf is designed to be positioned on top of the drawer box. The two drawers create extra storage space for the customer. The additional in-built wine rack creates a practical storage area for bottles. Please note that the wine rack shelf dividers are set back 100mm for the wine bottle necks to hang. This allows the doors of the modular unit to close without interference.

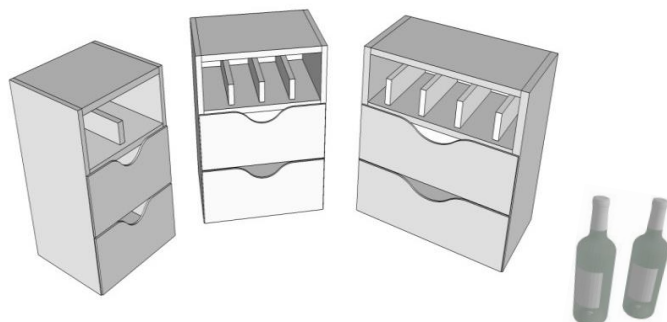

- 2 bottles can be stored - 314mm wide version
- 4 bottles can be stored - 414mm wide version
- 5 bottles can be stored - 514mm wide version

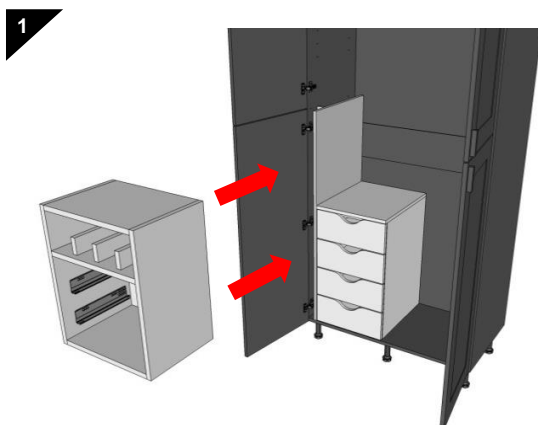
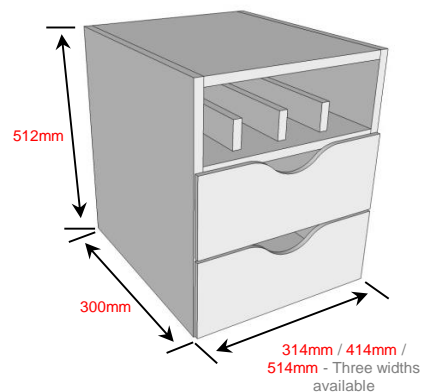

Insert the x2 Drawer Box with Wine Rack Shelf on top of the drawer box:

- Position the x2 drawer box with wine rack shelf on top of the drawer box. Position on top of drawer box.

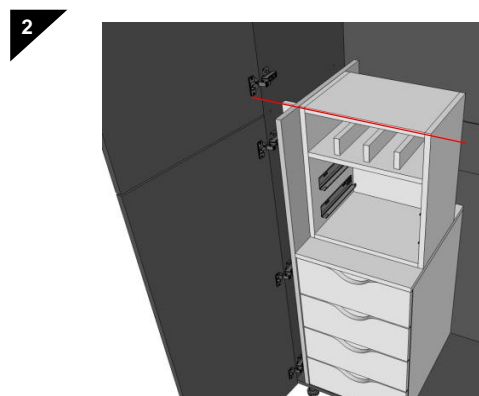

Ensure the FRONT of the x2 drawer box with wine rack is align with the smaller spacer on the divider set:

- The x2 drawer box with wine rack shelf should be align with the positioning of the smaller spacer.

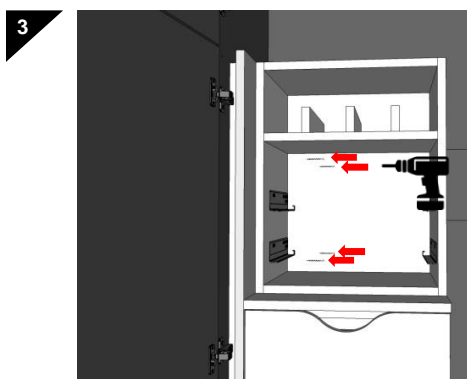

Fix the x2 drawer box with wine rack shelf into the divider set:

- Use screws & fix as discretely as possible into

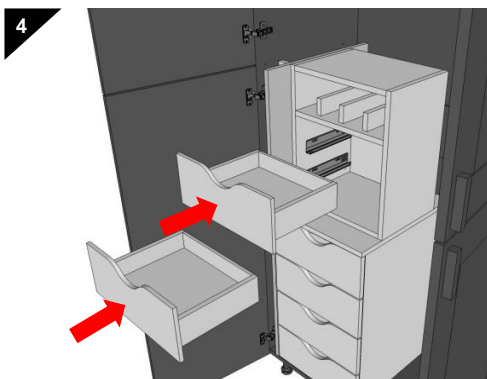

Reinsert the drawers into the drawer box:

- Reinsert the drawers back into the drawer box. The x2 drawer box with wine rack shelf is now fitted.

Modular Units - Planning Information:

Loose shelving:

The loose shelves **SUPPLIED** in the larder housing can be removed to allow space for the internal fitments. The fitter has the option to reinsert the shelving later to fill the spacing between internal fitments.

How many shelves are supplied in my larder housing?

There are a total of x6 shelves supplied with any of the modular unit larders. X1 shelf is full depth, x5 are reduced depth. See below for sizes & spec:

Additional full depth shelves:

The designer has the option to order additional loose shelves that are full depth. Refer to your product manual for codes & prices.

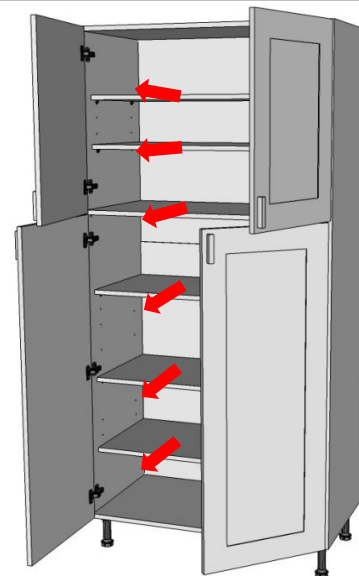

Tip: Wider shelves have the potential to bow when weight is applied. If the shelf shows signs of bowing, we recommend removing the shelf, rotating & reinserting the shelf whenever the user is cleaning the unit. This will remove any bowing. Repeat process when required.

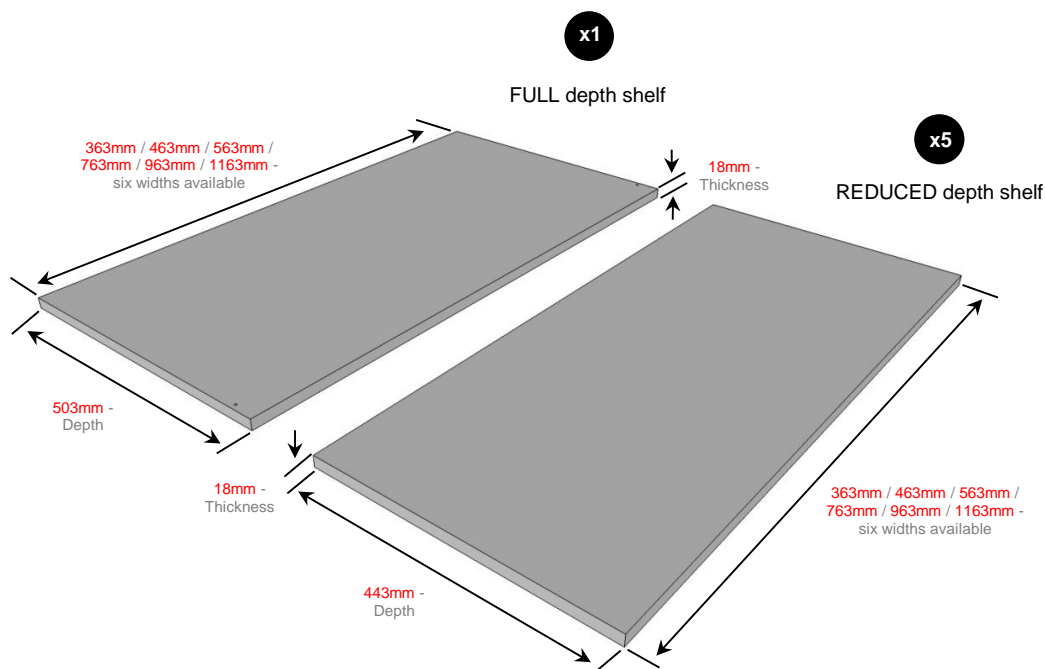

Shelf widths:

363mm wide shelf	-	Designed to suit a 400mm wide cabinet
463mm wide shelf	-	Designed to suit a 500mm wide cabinet
563mm wide shelf	-	Designed to suit a 600mm wide cabinet
763mm wide shelf	-	Designed to suit a 800mm wide cabinet
963mm wide shelf	-	Designed to suit a 1000mm wide cabinet
1163mm wide shelf	-	Designed to suit a 1200mm wide cabinet

Generic Product Specification - Modular Units - Wine Rack Shelf

Important Information: Shelf can be stacked on top of other two wine rack shelves.

MASTERCLASS®
KITCHENS

Modular Units - Planning Information:

Wine Rack Shelf:

The Wine rack shelf is intended to be fitted on any shelf within the modular unit. The wine rack shelf is available to suit all modular unit houses. **Note:** The wine rack shelf is also available for 450mm & 900mm wide larders to add an elegant feature to the housing.

The wine rack shelf can be used in conjunction with the other two wine racks. Simply place the wine rack shelf on top of any of the two other wine racks to create additional wine bottle storage slots.

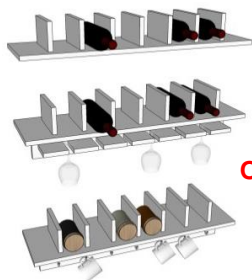

OR

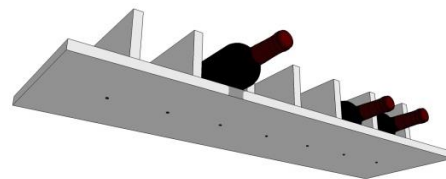

Screw heads are visible from the underside - Ensure shelf is placed on top of a shelf

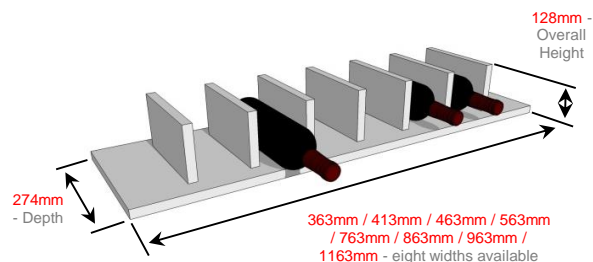

1

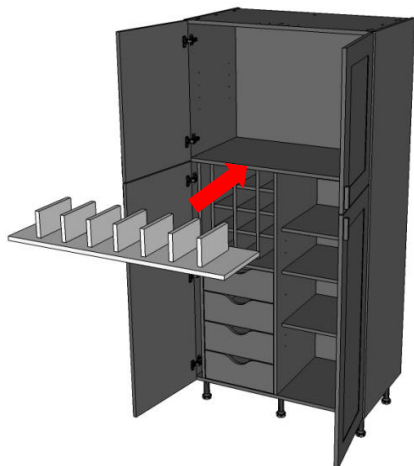

Insert the wine rack shelf inside the cabinet:

- Place the wine rack shelf inside the cabinet, on top of a shelf.

2

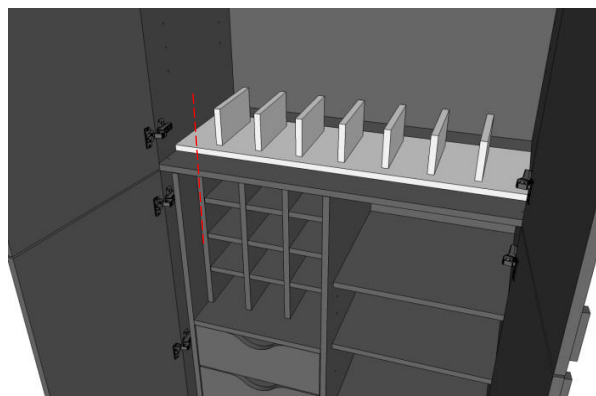

Ensure the wine rack shelf aligns with the positioning of the divider smaller spacer & box wine rack:

- All internal fitments should align in positioning.

3

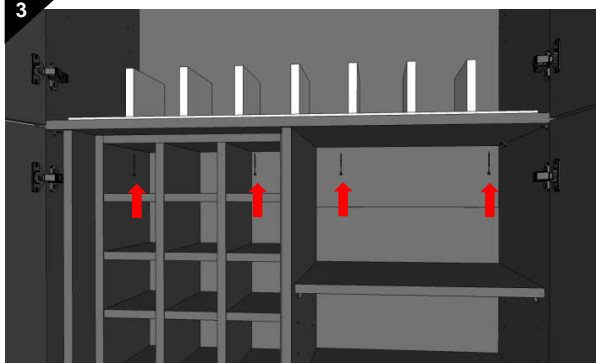

Fix the shelf from the underside:

- Screw from under the shelf & box wine rack. This will secure the wine rack shelf.



4

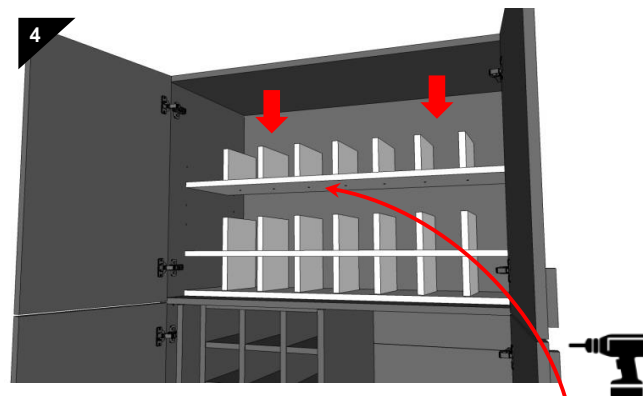

Optional - place additional wine rack shelves on top:

- The fitter can place more wine rack shelves on top of the initial wine rack shelf; do not attempt to fix.
- Note: The more shelves inserted, the more additional fixings will be



Modular Units - Planning Information:

Wine Rack Shelf with Wine Glass Holder:

The Wine rack shelf with wine glass holder is intended to be fitted inside the modular unit in place of any shelf position. Unlike the wine rack shelf, this shelf is designed to be fixed into the cabinets side cheeks with L tags.

The wine rack shelf with wine glass holder can be used in conjunction with the wine rack shelf. Simply place the wine rack shelf on top of the wine rack shelf with wine glass holder.

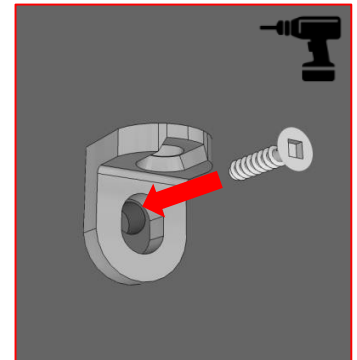
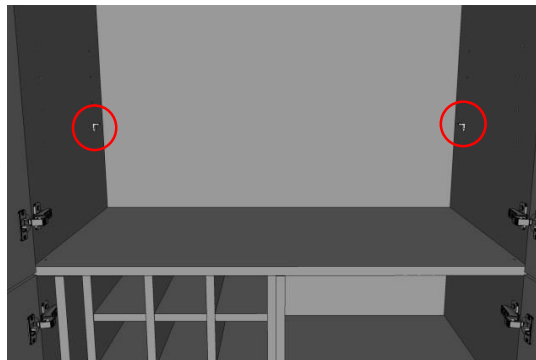
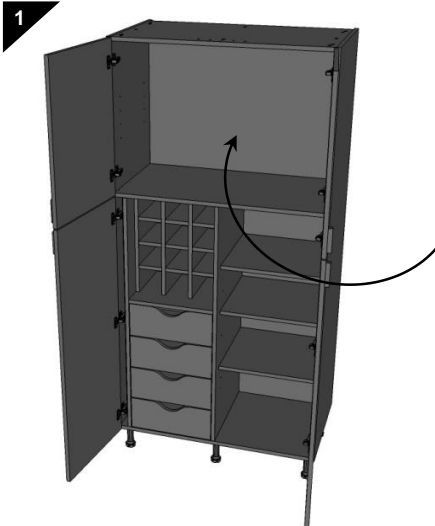
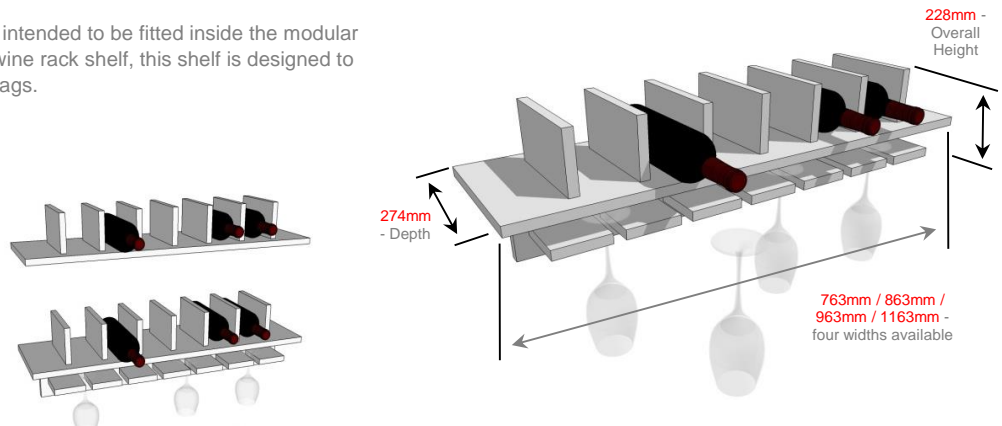

Begin by inserting x2 L tags into any back x2 shelf holes:

- Place the x2 shelf L tags into position. The back L tags must be fitted to allow a surface for the wine rack shelf with wine glass holder.

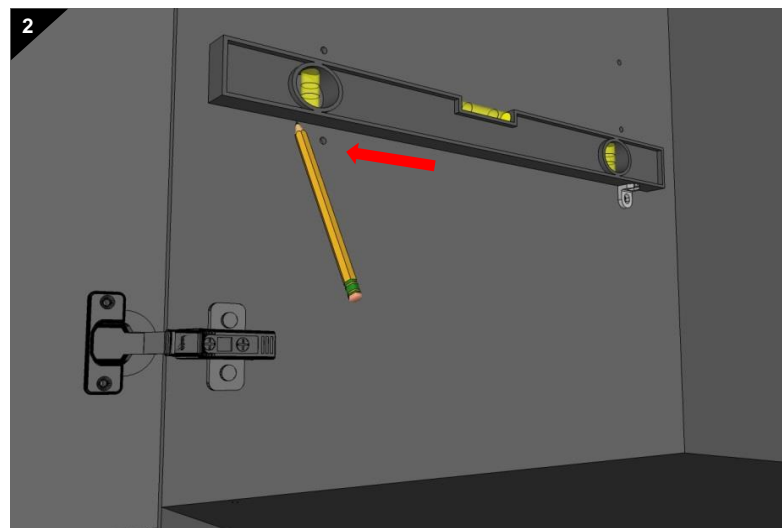

Measure The level & mark for the next set of L tags:

- Use a spirit level on top of the back x2 L tags fitted.
- Ensure the spirit level is level.
- Using a pencil, mark an accurate guide line for the wine rack shelf with wine glass holder.
- The second set of L tags will be fitted to the wine rack shelf.

Generic Product Specification - Modular Units - Wine rack shelf with wine glass holder

Important Information: Fix into larders with L tags supplied.

MASTERCLASS®
KITCHENS

Modular Units - Planning Information:

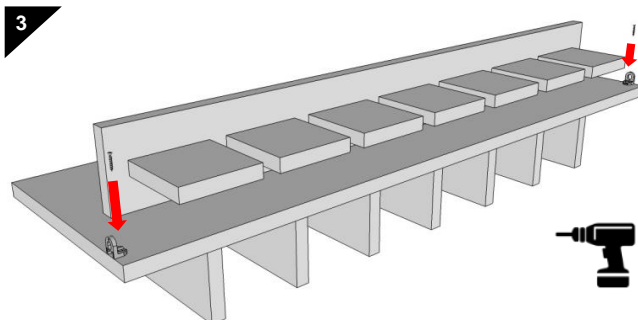

Refer to the wine rack shelf with wine glass holder - turn over & fix L tags:

- Turn the wine rack shelf with wine glass holder onto its underside.
- Fix the L tags near the FRONT of the glass holder section.
- The fitter can position these L tags anywhere, but not on the edge. Allow a purpose step back.

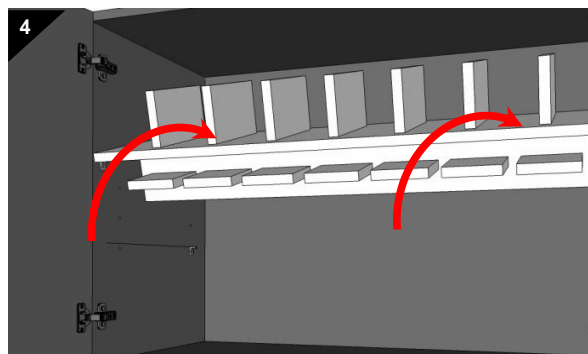

Place the wine rack shelf with wine glass holders into the modular unit:

- Insert the wine rack shelf with wine glass holder into the cabinet.
- Place the back of the wine rack shelf onto the fitted L tags fitted earlier.

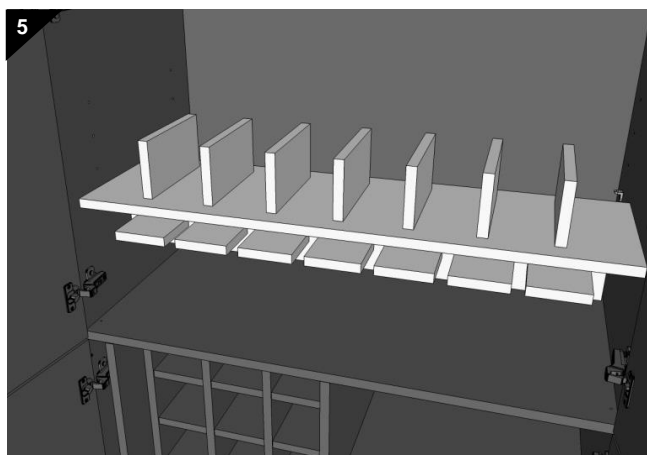

Ensure the wine rack shelf with wine glass holders is pushed to the back of the cabinet:

- Slide the wine rack shelf with wine glass holders to the back of the cabinet.

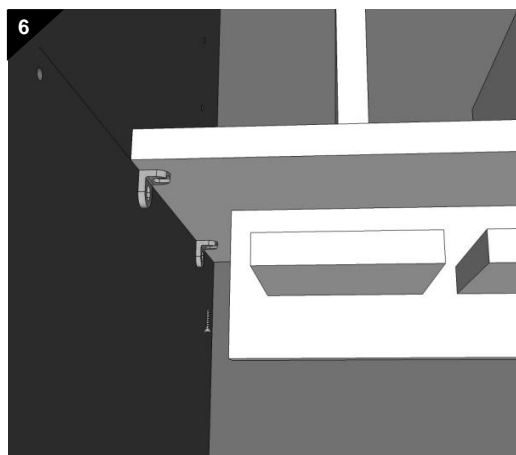

Fix the BACK L tags into the Wine rack shelf with wine glass holders:

- The wine rack shelf with wine glass holders should be in line with the pencil guide line.
- Fix the **BACK** x2 L tags into the wine rack shelf.

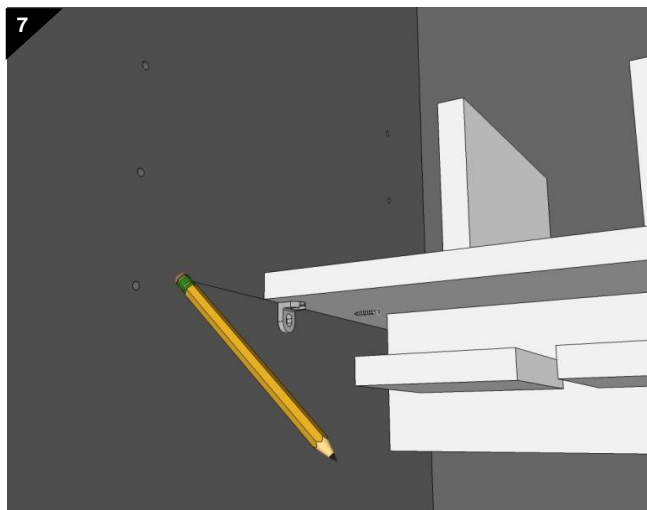

Fix the FRONT L tags into the Cabinet side cheeks & erase pencil line:

- Apply screws & fix the FRONT L tag into the cabinet side cheeks.
- Erase the pencil guide line as the fit is now completed.

Modular Units - Planning Information:

Wine Rack Shelf with Cup Holders:

The Wine rack shelf with Cup holders is intended to be fitted inside the modular unit in place of any shelf position. Unlike the wine rack shelf, this shelf is designed to be fixed into the cabinets side cheeks with L tags.

The wine rack shelf with Cup holders can be used in conjunction with the wine rack shelf. Simply place the wine rack shelf on top of the wine rack shelf with Cup holders.

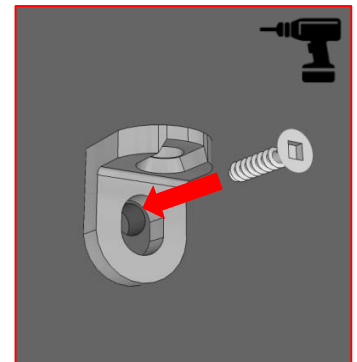
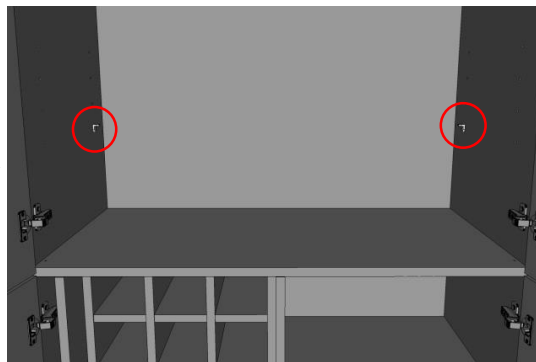
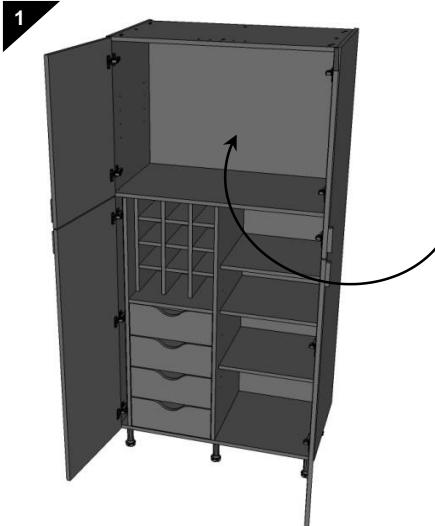
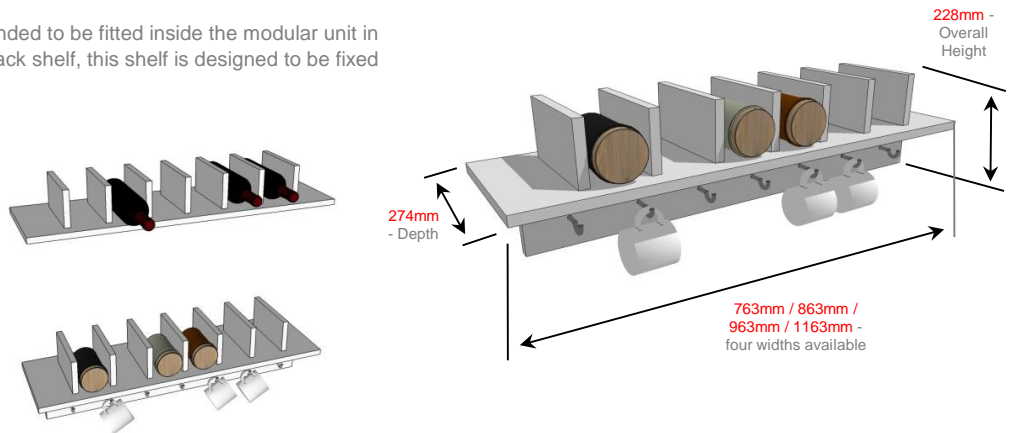

Begin by inserting x2 L tags into any back x2 shelf holes:

- Place the x2 shelf L tags into position. The back L tags must be fitted to allow a surface for the wine rack shelf with cup holders.

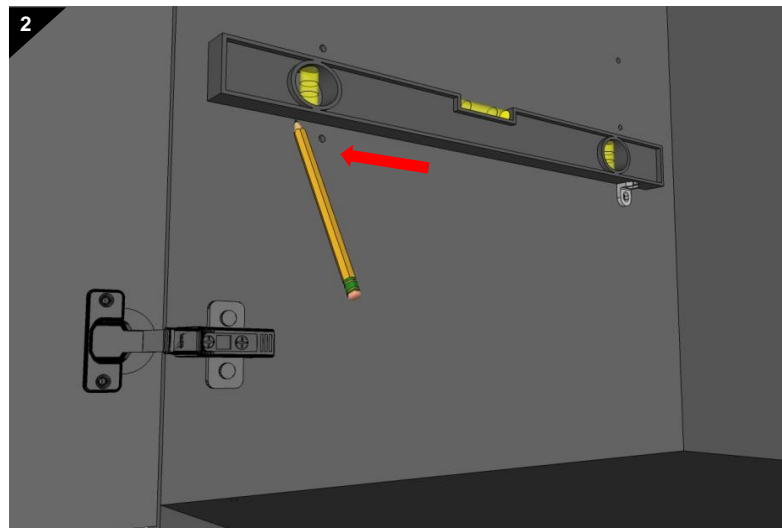

Measure The level & mark for the next set of L tags:

- Use a spirit level on top of the back x2 L tags fitted.
- Ensure the spirit level is level.
- Using a pencil, mark an accurate guide line for the wine rack shelf with cup holders.
- The second set of L tags will be fitted to the wine rack shelf.

Generic Product Specification - Modular Units - Wine rack shelf with cup holders

Important Information: Fix into ladders with L tags supplied.

MASTERCLASS®
KITCHENS

Modular Units - Planning Information:

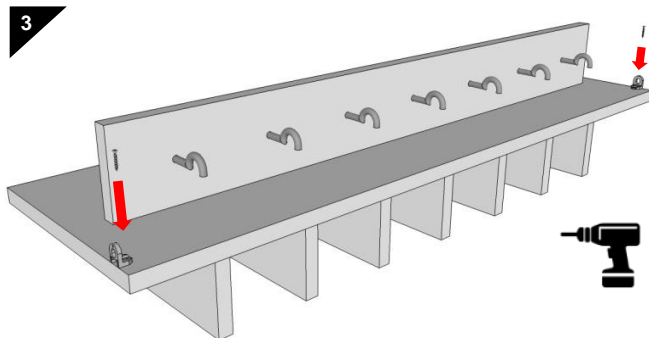

Refer to the wine rack shelf with cup holders - turn over & fix L tags:

- Turn the wine rack shelf with cup holders onto its underside.
- Fix the L tags near the FRONT of the cup holders section.
- The fitter can position these L tags anywhere, but not on the edge. Allow a purpose step back.

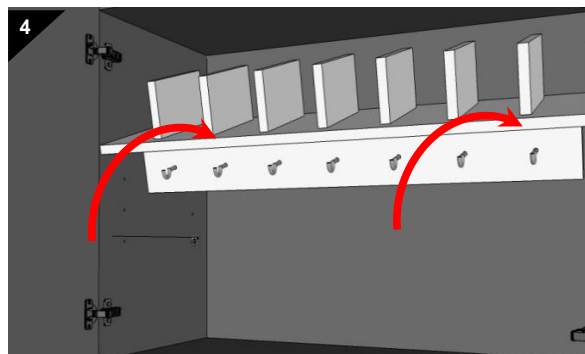

Place the wine rack shelf with cup holders into the modular unit:

- Insert the wine rack shelf with cup holders into the cabinet.
- Place the back of the wine rack shelf onto the fitted L tags fitted earlier.

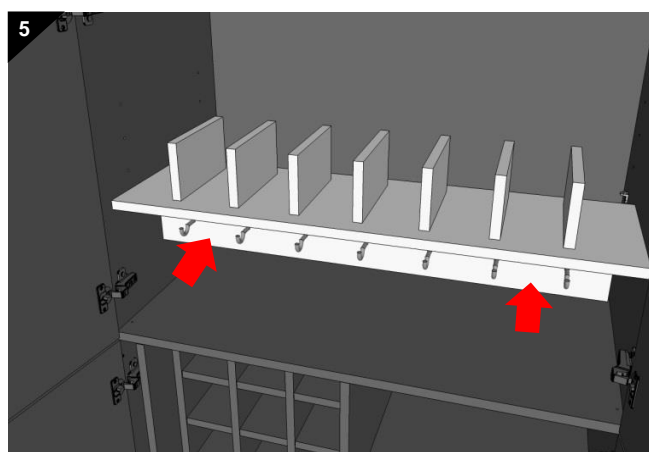

Ensure the wine rack shelf with cup holders is pushed to the back of the cabinet:

- Slide the wine rack shelf with cup holders to the back of the cabinet.

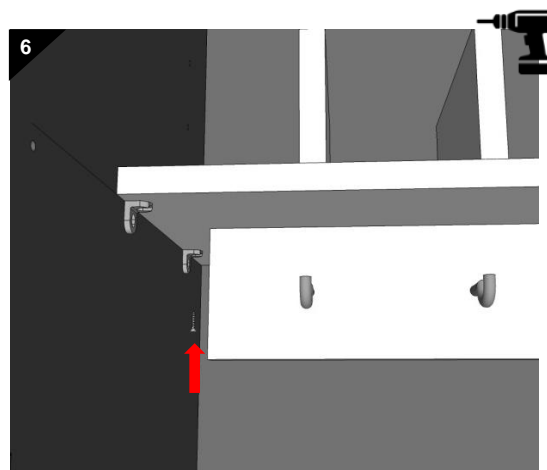

Fix the BACK L tags into the Wine rack shelf with cup holders:

- The wine rack shelf with cup holders should be in line with the pencil guide line.
- Fix the **BACK** x2 L tags into the wine rack shelf.

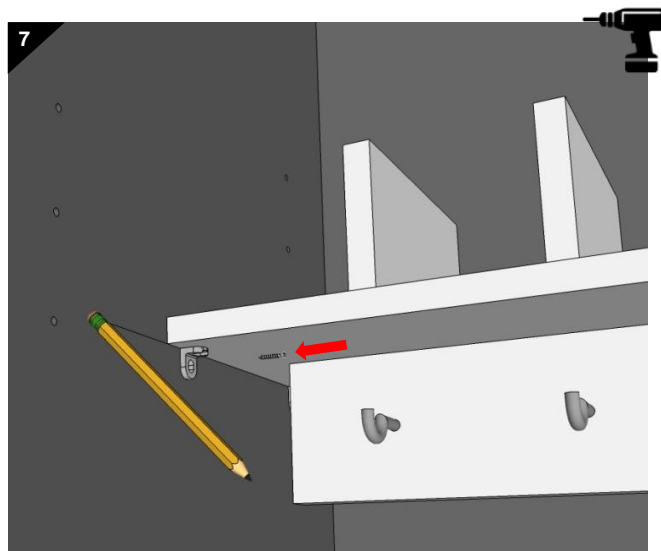

Fix the FRONT L tags into the Cabinet side cheeks & erase pencil line:

- Apply screws & fix the FRONT L tag into the cabinet side cheeks.
- Erase the pencil guide line as the fit is now completed.

The Modular Unit - Flyover Wine Rack Shelving:

Fitting the Wine Rack Shelves as Fly over shelving :

The modular units wine rack shelving range (Three styles) can be used as flyover shelves between units. To use these shelves in this scenario, apply the following fitting methods:

Important Notice: These wine rack shelves are intended primarily for **INSIDE** the modular units. If the fitter intends to fit these shelves between units, they must use additional show sides on the adjacent units to bridge the gap.

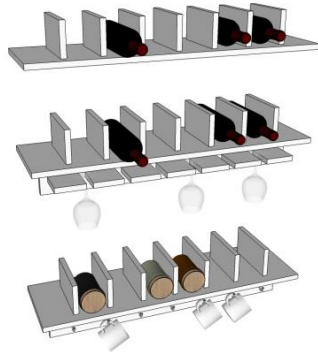

Using L tags between units:

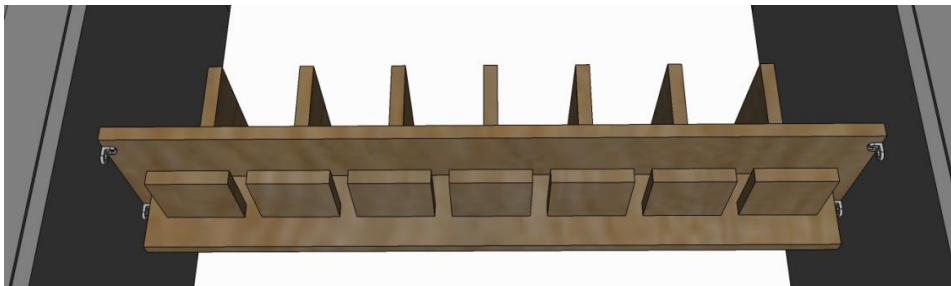

x4

Fix with L tags into the adjacent units show sides:

- The fitter must cut the show sides & fit them to the adjacent units prior to fitting the wine rack shelf.
- Use x4 L tags to fix into place.



Building a 3 piece flyover shelf display:

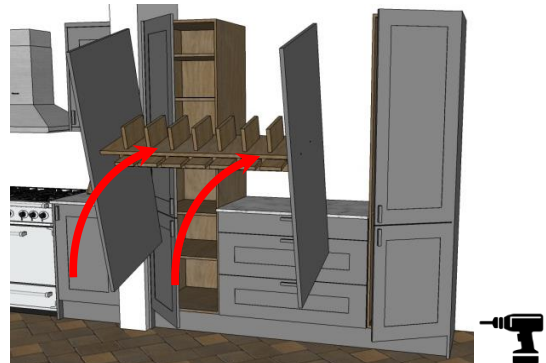
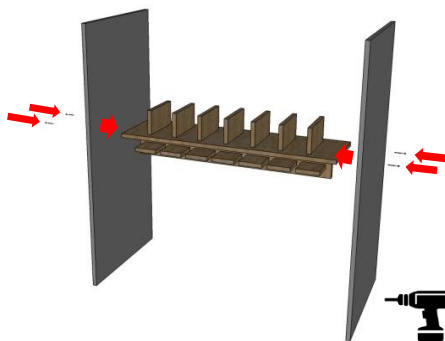

Fix the show sides to the wine rack shelf from the outside, & fix through the cabinet housings:

- Assemble the x2 show sides to the wine rack shelf with Hilo screws.
- Offer the 3 piece wine rack shelf between the larders. Fix from with the larders through into the show sides. Use 3/4 8 screws.

Generic Product Specification - Modular Units - Fitting method 1

Important Information: The following fit shows how to position & fix all internal fitments into the modular unit.

MASTERCLASS®
KITCHENS

Fitting the Modular Unit in practice:

The Modular unit has been designed to be fully interchangeable with all internal fitments available to this unit range. Modular units 800mm wide & above are supplied flat packed due to the overall size & weight of the cabinets housing. The following instructions will guide the fitter step-by-step for assembling the following configuration below. This style of modular unit can be personalised & exchanged for different internal fitments as shown.

Interchangeable Internal Fitments:

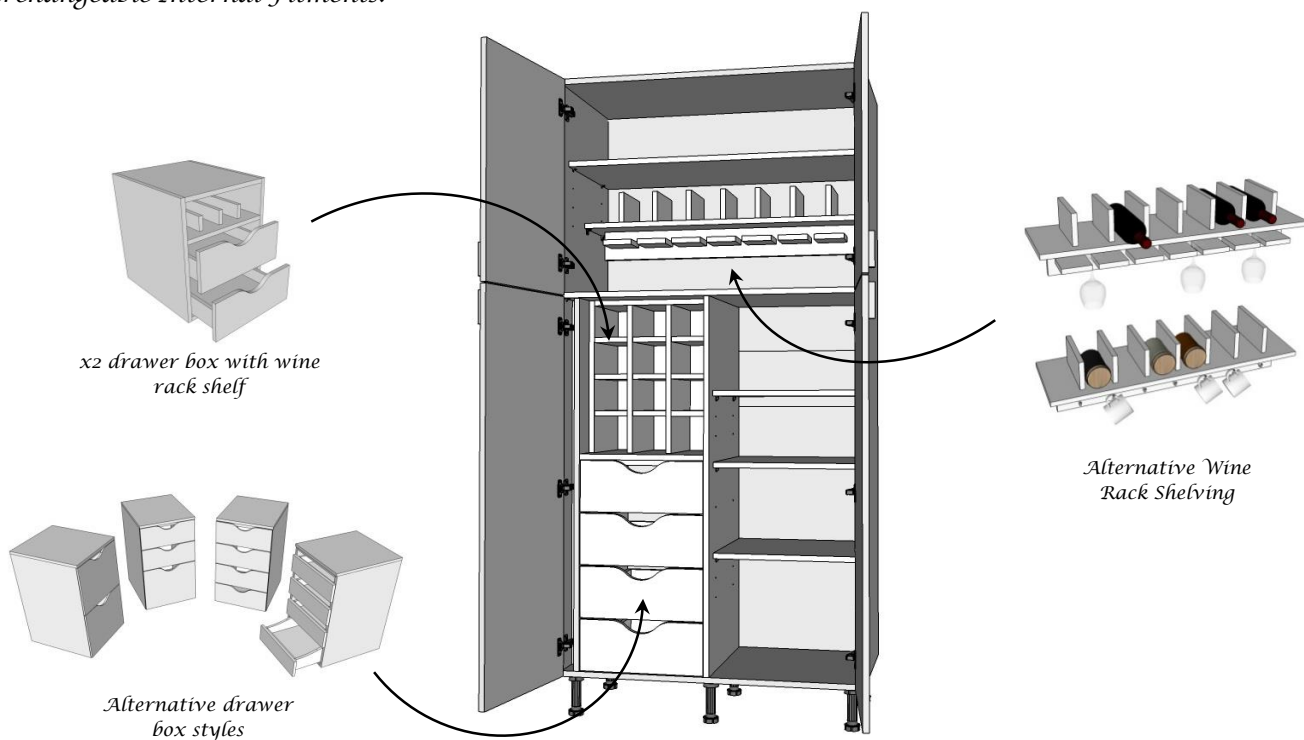

800, 1000 & 1200mm wide modular units - Flat Pack Larder Housing:

Modular units 800, 1000 & 1200mm wide are supplied flatpacked. The fitter must first build the housing BEFORE filling the cabinet with the internal fitments. Refer to the Flat Pack larder Instructions in order to assemble the housing.

Note: ALL internal fitments are supplied **FULLY ASSEMBLED** ready for fitting.

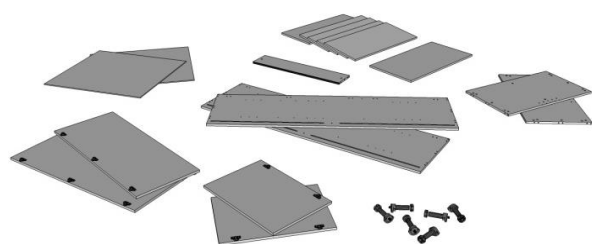

Step 1, Step 2, Step 3...

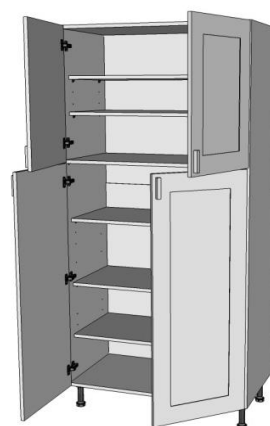

The Modular Unit Fitting Process:

Step 1 - Fitting the Divider Pack:

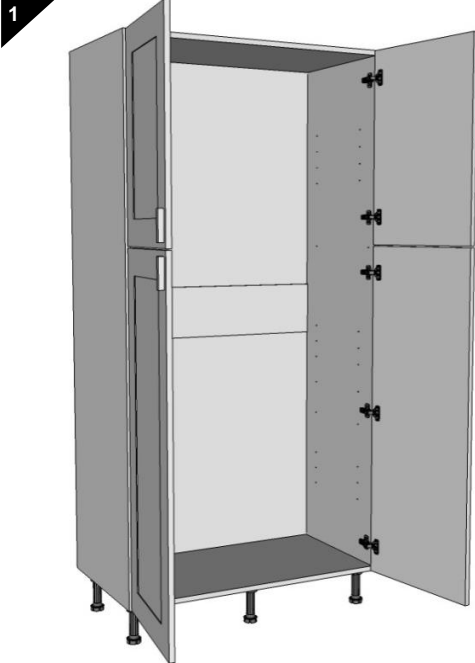

Begin with the larder housing:

- Ensure larder is ready for the internal fitments by removing all x6 shelves.
- Doors must be adjusted / levelled correctly prior to fixing the internal fitments.

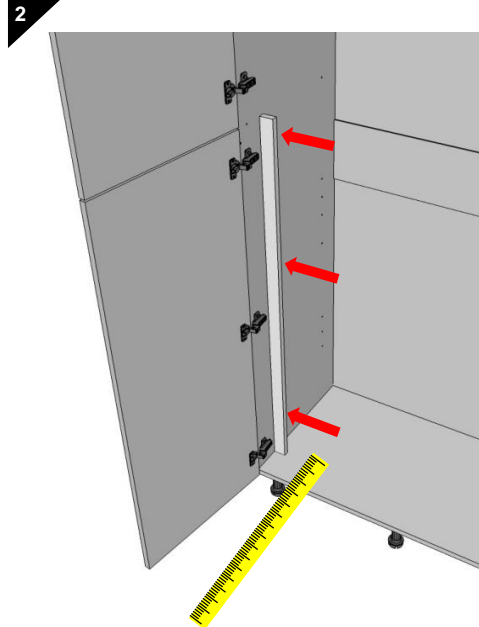

Insert the smaller spacer into the housing:

- Position & measure the distance from the front of the cabinet.
- Ensure the spacer is set back & clears the hinges. We recommend setting the spacer 100mm from the front edge.

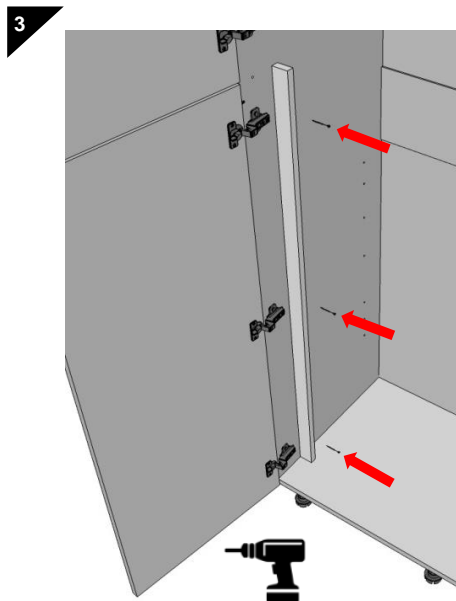

Fix with screws into the side cheek:

- Fix through the smaller spacer with Hilo screws into the cabinets side cheek.

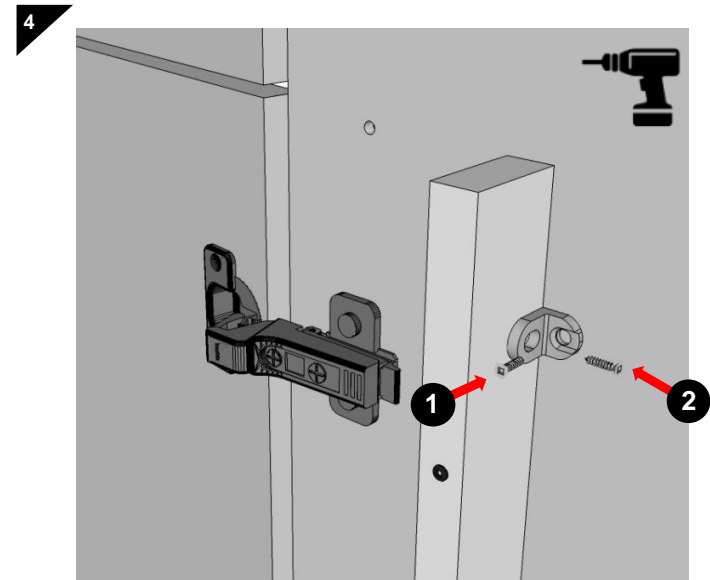

Use L tags for additional strength BEHIND the spacer out of sight:

- Fix x2 L tags (top & bottom of spacer) between the cabinet (1) & the spacer (2).

Generic Product Specification - Modular Units - Fitting method 1

Important Information: The following fit shows how to position & fix all internal fitments into the modular unit.

MASTERCLASS®
KITCHENS

The Modular Unit Fitting Process:

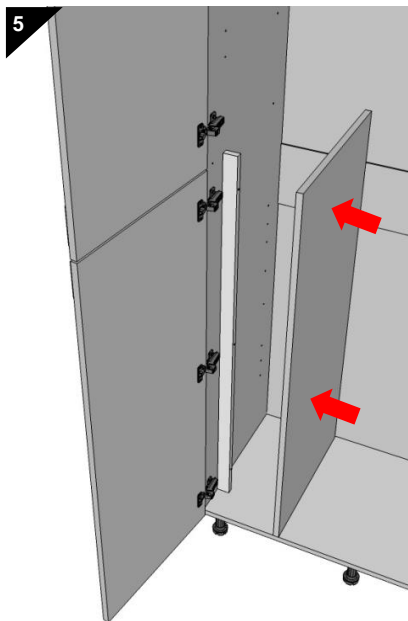

Place the full depth panel against the smaller spacer:

- Place the spacer against the smaller divider. Ensure the full depth panel is fitted to the back of the cabinet's interior.
- **Note:** This full depth panel will feature x6 pre drilled holes. These serve no purpose. The full depth panel is simply a shared component to the Half loose shelf & division set.

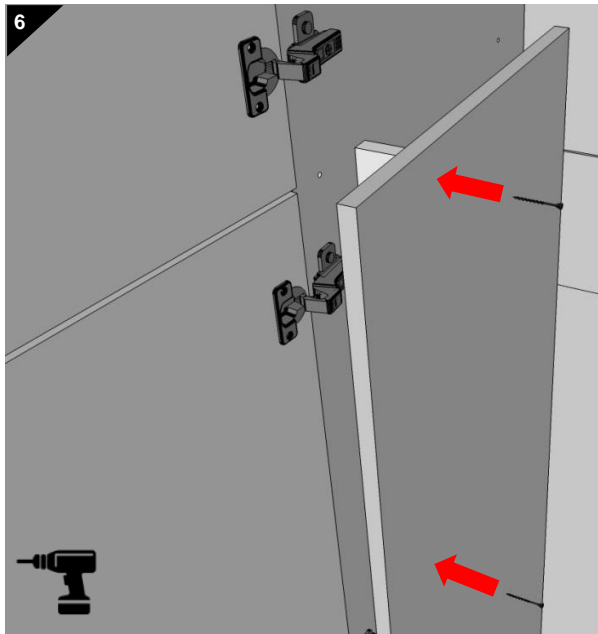

Use Hilo screws to fix into smaller spacer:

- Fix through the full depth panel into the smaller spacer to secure the panel. The divider pack set is now fitted ready for the next fitment.

Step 1 completed. Next Step - Fitting the drawer box

Step 2 - Fitting the Drawer box:

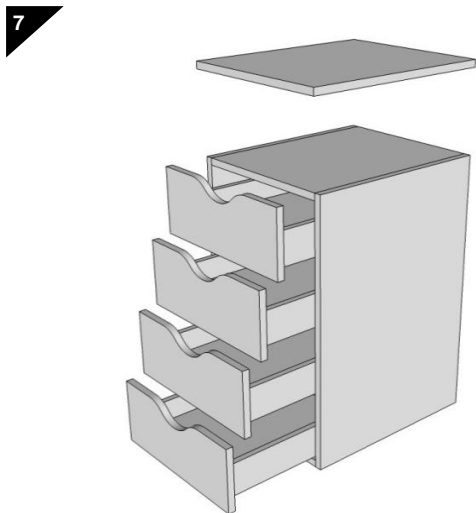

Remove the drawers from the cabinet:

- Place hands under each drawer & pull Movento runner mech to release drawer.

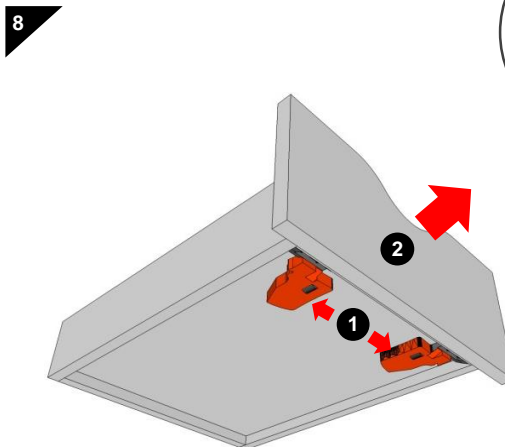

How to remove the drawer boxes:

- Place hands under the drawer box & grip the Movento locking mechanism (1) & pull towards the edges of the drawer. This will release the drawer from the runners.
- Pull the drawer away from its runners to successfully remove the drawer.

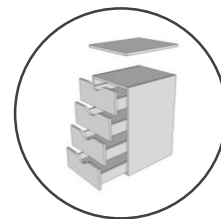

The Modular Unit Fitting Process:

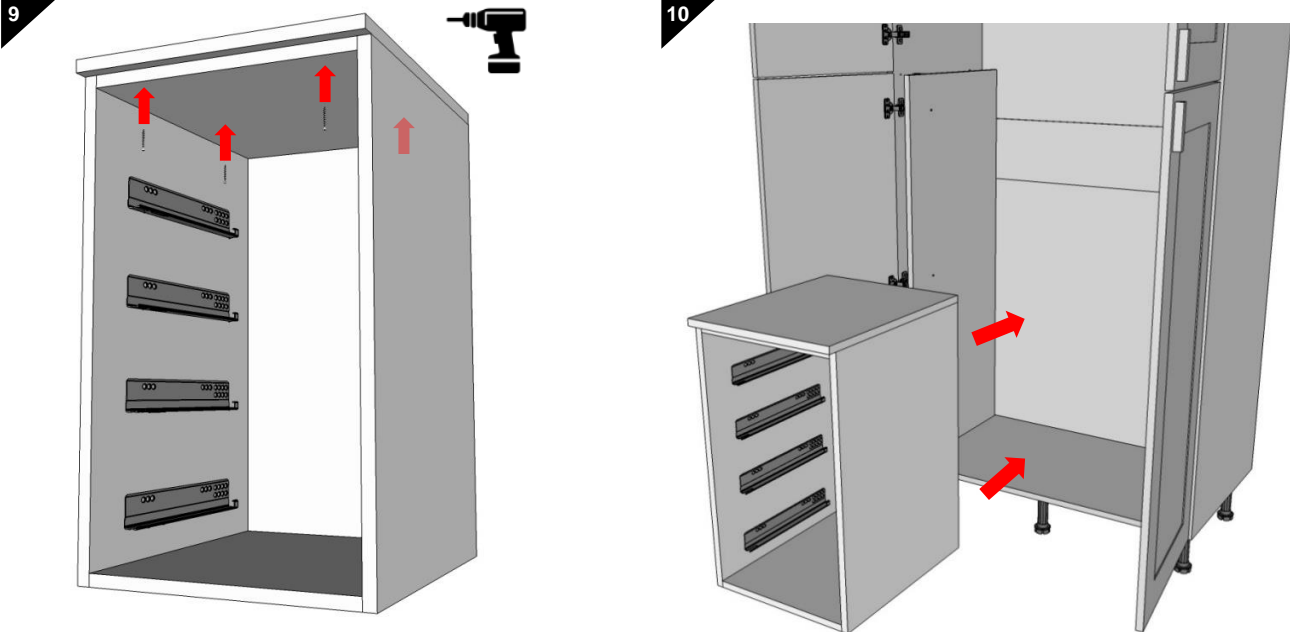

Fix top shelf with screws:

- Position the shelf so the front is overlaying the cabinet frontage - the back of the shelf should be flush with the back of the cabinet.

Insert drawer box into the larder housing:

- Position the drawer box next to the divider.

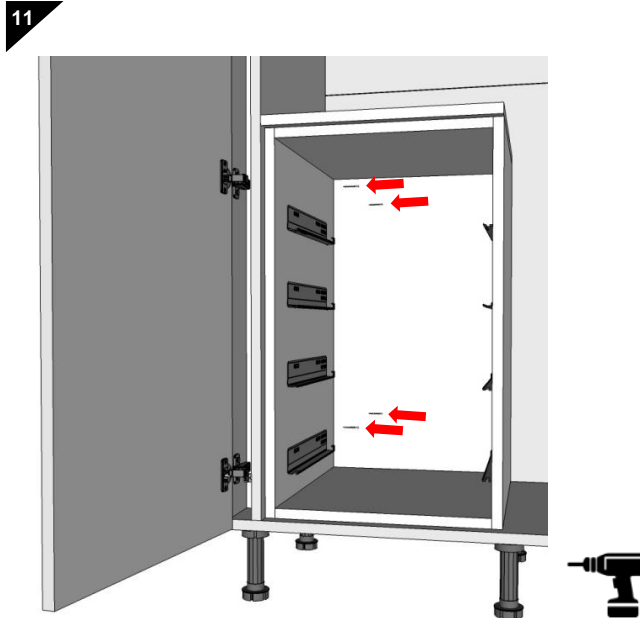

Fix the drawer box into the divider:

- Fix from within the drawer box cabinet.
- We recommend not fitting the drawer boxes yet - Leave the drawer boxes aside until further fitments have been fitted.

Generic Product Specification - Modular Units - Fitting method 1

Important Information: The following fit shows how to position & fix all internal fitments into the modular unit.

MASTERCLASS®
— KITCHENS —

The Modular Unit Fitting Process:

Step 3 - Fitting the Box Wine Rack:

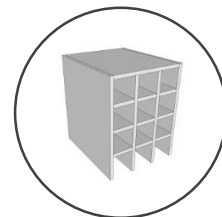

12

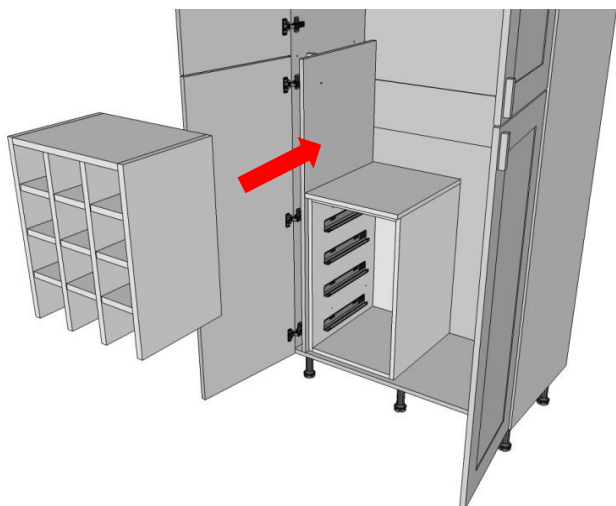

Insert box wine rack on top of drawer box:

- Place box wine rack into position.

13

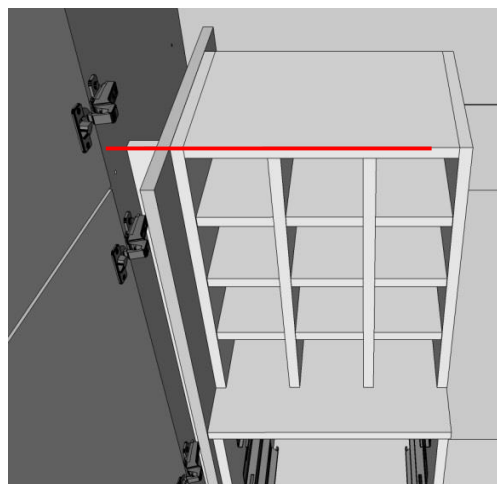

Ensure box wine rack & smaller spacer aline:

- The box wine rack should align with the frontage of the smaller spacer (division pack).

14

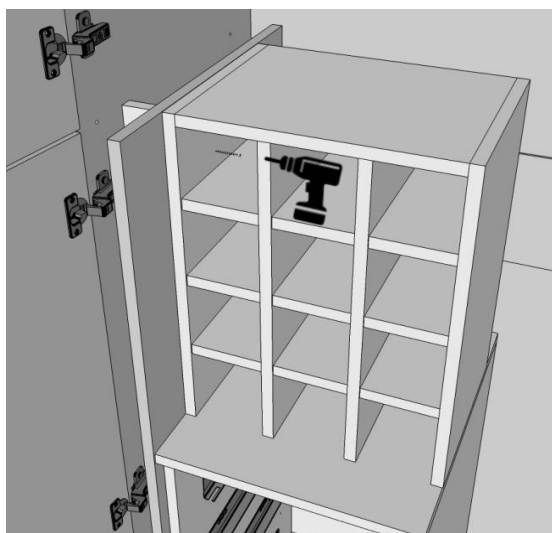

Fix from within the box wine rack into the division pack:

- Use 3/4 8 screws to fix inside the box wine rack, through into the division pack full depth panel.

15

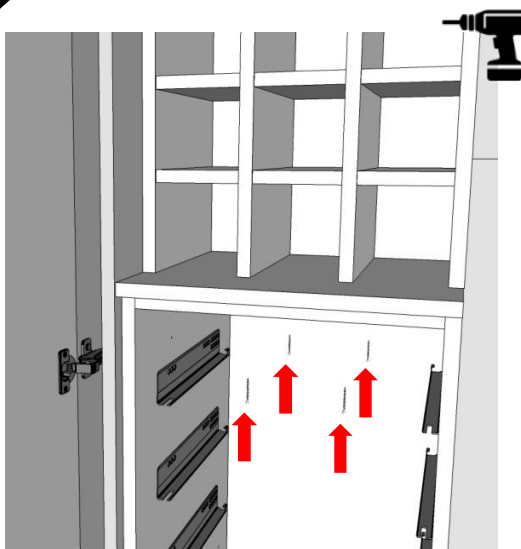

Fix from the underside of the drawer box into the box wine rack:

- Use 3/4 8 screws to fix inside the drawer box through into the box wine rack.

Step 3 completed. Next Step - Fitting the Half Loose Shelves & Division Set

The Modular Unit Fitting Process:

Step 4 - Fitting the Fitting the Half Loose Shelves & Division Set:

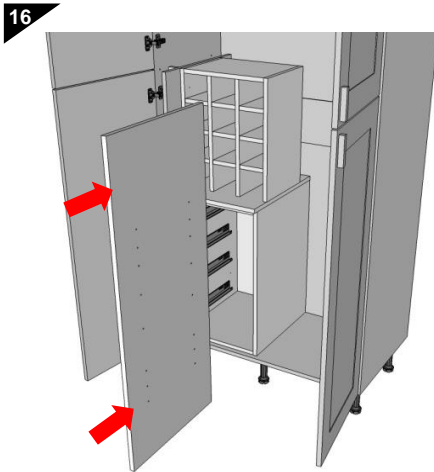

Insert the full depth panel with shelf holes on show:

- **ENSURE** the shelf holes align.

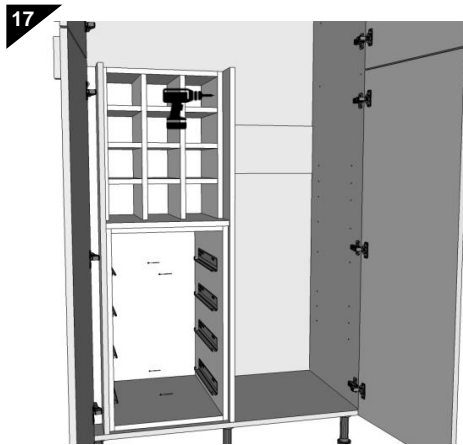

Fix the panel through the drawer box & box wine rack:

- Use 3/4 8 screws to fix the panel in place.

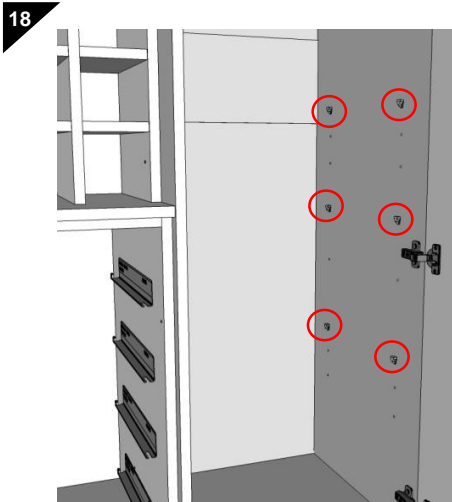

Insert the shelf pegs into the desired positions:

- The fitter can position the shelves in any position.

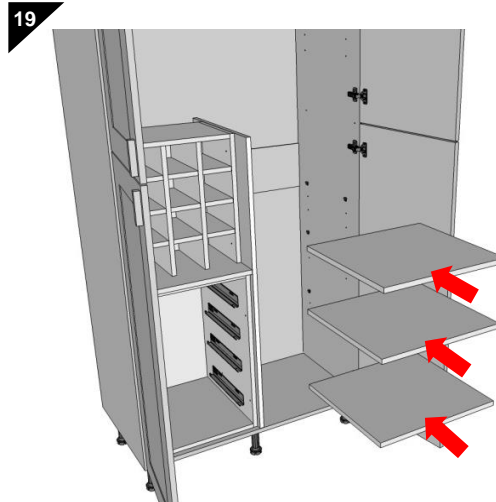

Insert shelves into the cabinet:

- Rest shelves on top of shelf pegs.

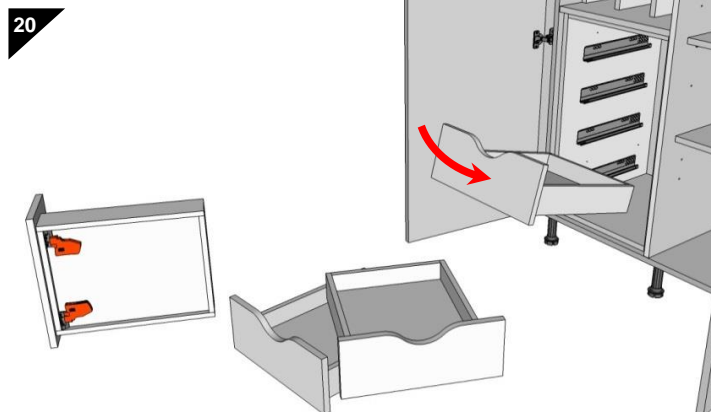

Insert drawers into the drawer box:

- All fixings for the lower level of the modular unit are now complete. The fitter can now reinsert the drawers into the housing.

Step 4 completed. Next Step - Fitting the Full depth shelf

Generic Product Specification - Modular Units - Fitting method 1

Important Information: The following fit shows how to position & fix all internal fitments into the modular unit.

MASTERCLASS®
KITCHENS

The Modular Unit Fitting Process:

Step 5 - Fitting the Full depth shelf:

21

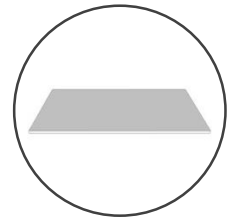
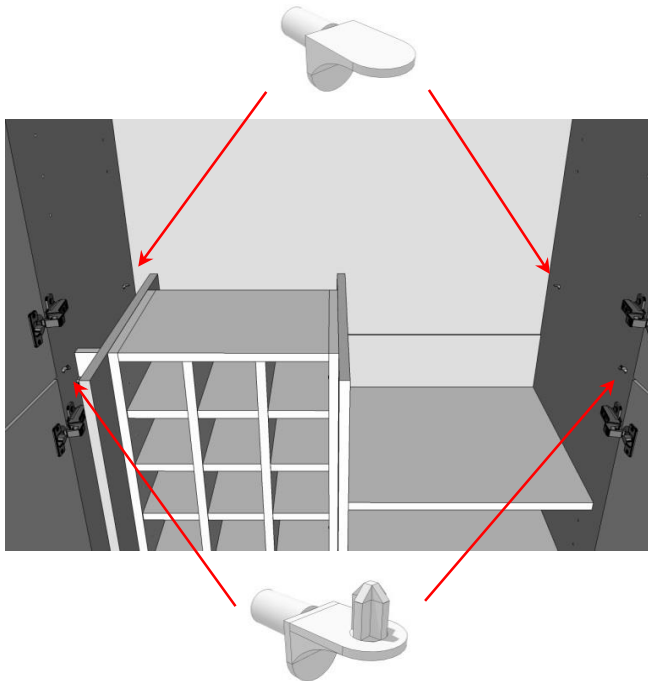

Insert the following shelf pegs into position:

- The metal lug shelf pegs (FRONT) provide a stable support for the shelf, ensuring it doesn't slide out of the cabinet.

22

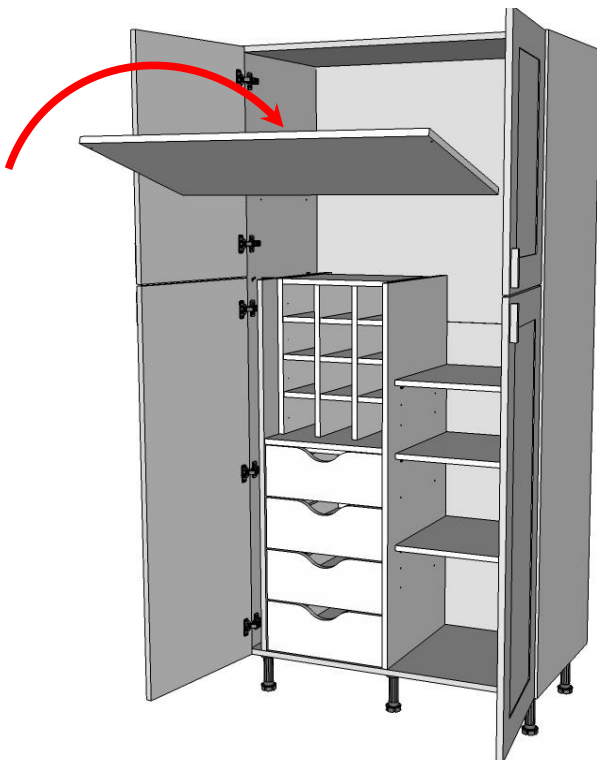

Insert the shelf into the cabinet housing:

- The full depth shelf features x2 small holes - these are to suit the metal lug shelf pegs.
- Insert the shelf on top of the shelf pegs to fit the shelf.

Step 5 completed. Next Step - Fitting the Wine Rack shelf with Wine Glass Holder

The Modular Unit Fitting Process:

Step 6 - Fitting the Wine Rack shelf with Wine Glass Holder:

22

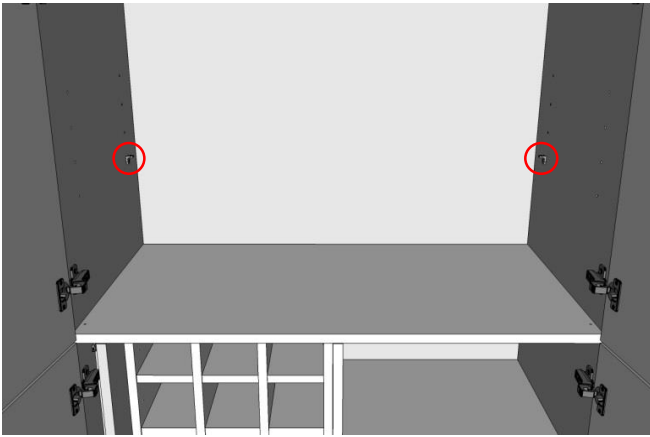

Begin by inserting x2 L tags into any back x2 shelf holes:

- Place the x2 shelf L tags into position. The back L tags must be fitted to allow a surface for the wine rack shelf with wine glass holder.

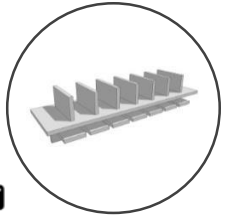
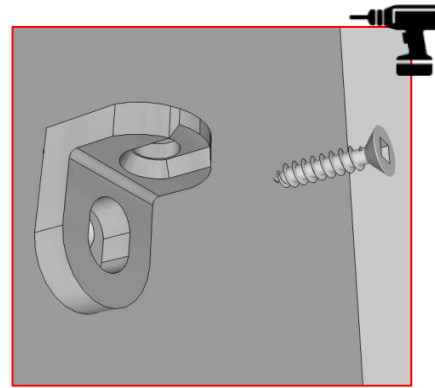

22

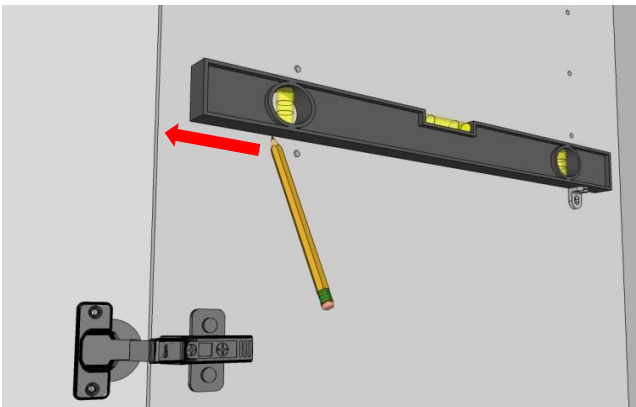

Measure The level & mark for the next set of L tags:

- Use a spirit level on top of the back x2 L tags fitted.
- Ensure the spirit level is level.
- Using a pencil, mark an accurate guide line for the wine rack shelf with wine glass holder.
- The second set of L tags will be fitted to the wine rack shelf.

23

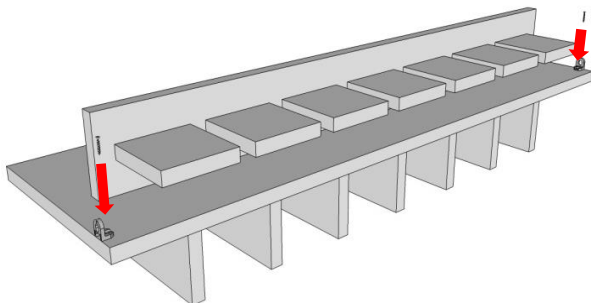

Refer to the wine rack shelf with wine glass holder - turn over & fix L tags:

- Turn the wine rack shelf with wine glass holder onto its underside.
- Fix the L tags near the FRONT of the wine glass holder section.
- The fitter can position these L tags anywhere, but not on the edge. Allow a purpose step back.

24

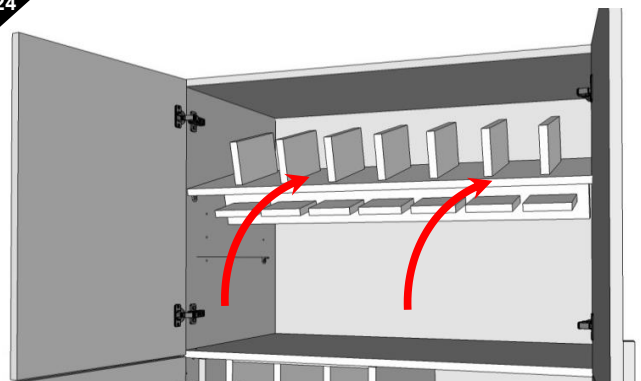

Place the wine rack shelf with wine glass holder into the modular unit:

- Insert the wine rack shelf with wine glass holder into the cabinet.
- Place the back of the wine rack shelf onto the fitted L tags fitted earlier.

Generic Product Specification - Modular Units - Fitting method 1

Important Information: The following fit shows how to position & fix all internal fitments into the modular unit.

MASTERCLASS®
KITCHENS

The Modular Unit Fitting Process:

25

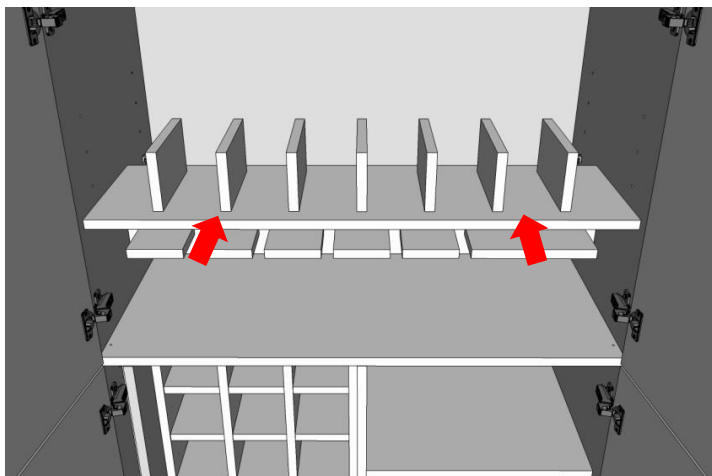

Ensure the wine rack shelf with wine glass holders is pushed to the back of the cabinet:

- Slide the wine rack shelf with wine glass holder to the back of the cabinet.

26

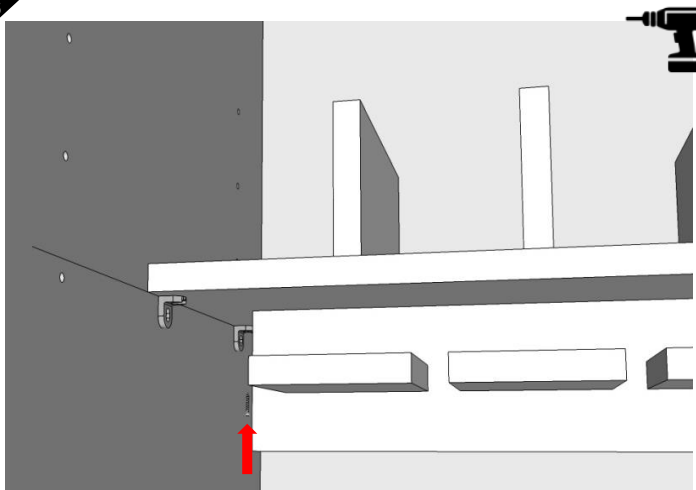

Fix the BACK L tags into the Wine rack shelf with wine glass holder:

- The wine rack shelf with wine glass holders should be in line with the pencil guide line.
- Fix the **BACK** x2 L tags into the wine rack shelf.

27

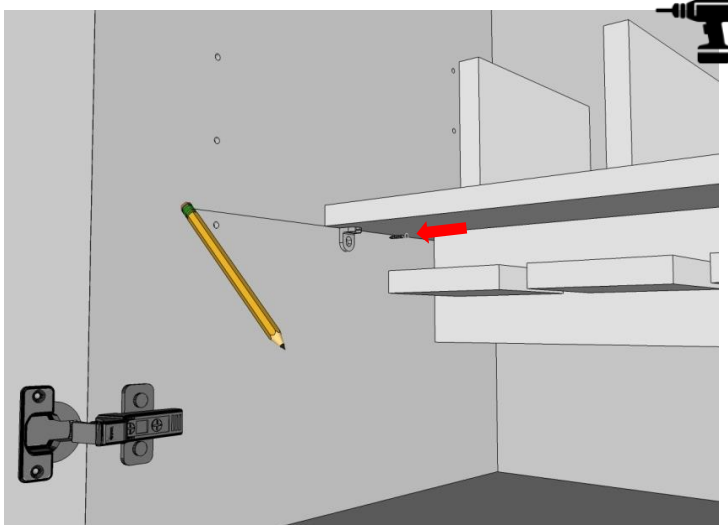

Fix the FRONT L tags into the Cabinet side cheeks & erase pencil line:

- Apply screws & fix the FRONT L tag into the cabinet side cheeks.
- Erase the pencil guide line as the fit is now completed.

Step 6 completed. Next Step - Fitting the reduced shelf

The Modular Unit Fitting Process:

Step 7 - Fitting the reduced shelf

28

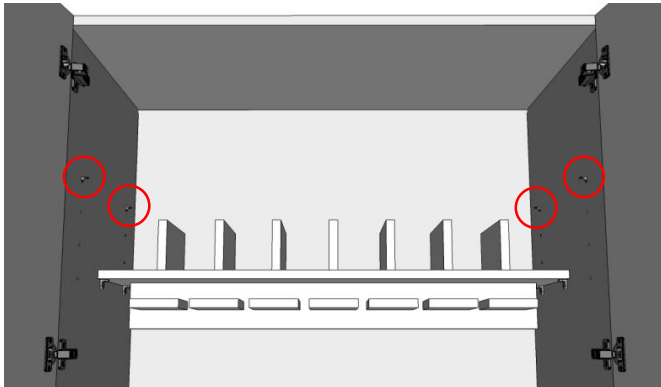

Insert Shelf pegs into the cabinets shelf holes:

- Use x4 metal shelf pegs for this shelf. The reduced shelves SUPPLIED with the cabinet do not feature small holes unlike the Full depth shelf SUPPLIED.

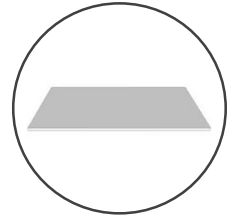
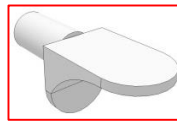

Insert the shelf into the cabinet:

- Position the shelf on top of the shelf pegs. Ensure shelf is pushed to the back of the cabinet.

29

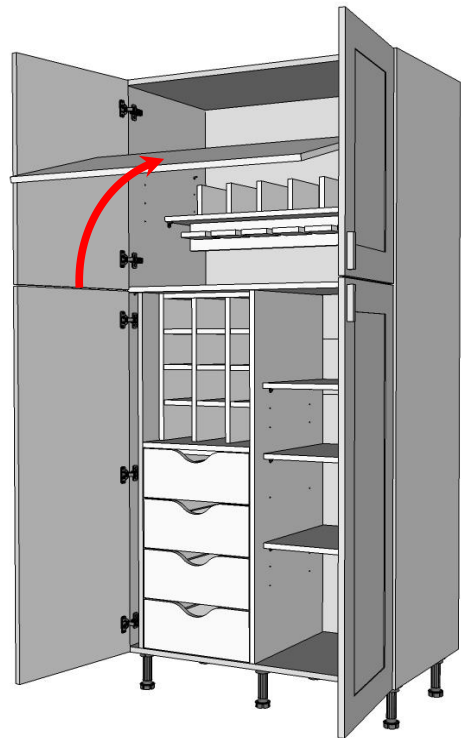

30

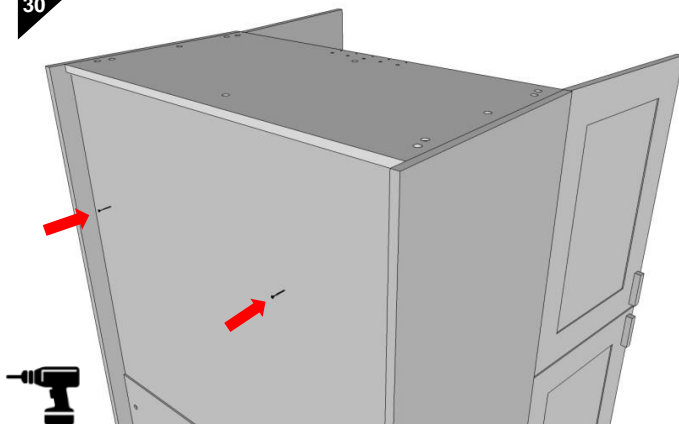

Extra security - Use additional screws:

- From the BACK of the cabinet, the fitter has the option to screw through the backboard into the shelf. This will provide extra strength.

Generic Product Specification - Modular Units - Fitting method 1

Important Information: The following fit shows how to position & fix all internal fitments into the modular unit.

MASTERCLASS®
KITCHENS

The Modular Unit Fitting Process:

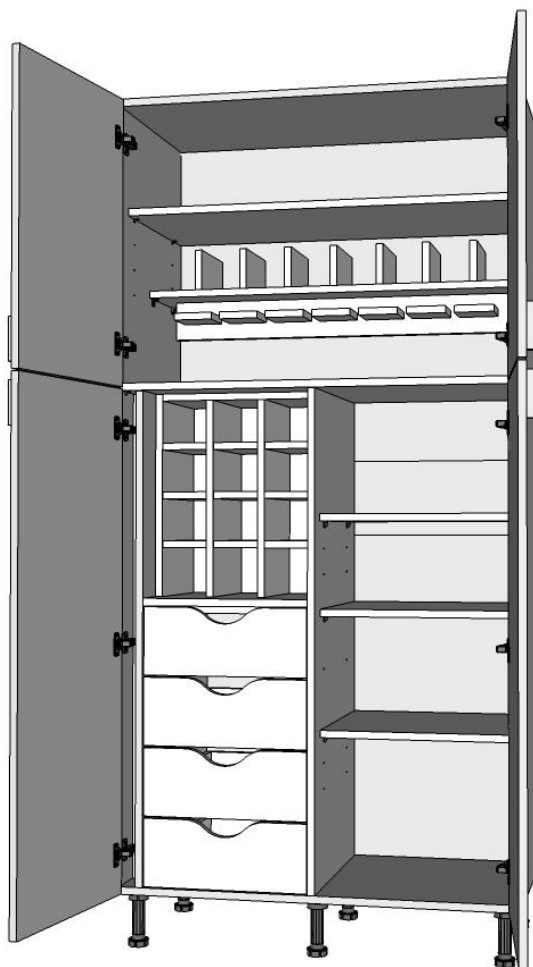

Symbol used in fit:



Drill - Icon refers to parts that can be drilled to fit together.

Fitting the Modular Unit in practice:

The Modular unit has been designed to be fully interchangeable with all internal fitments available to this unit range. Modular units 800mm wide & above are supplied flat packed due to the overall size & weight of the cabinets housing. The following instructions will guide the fitter step-by-step for assembling the following configuration below. This style of modular unit can be personalised & exchanged for different internal fitments as shown.

Interchangeable Internal Fitments:

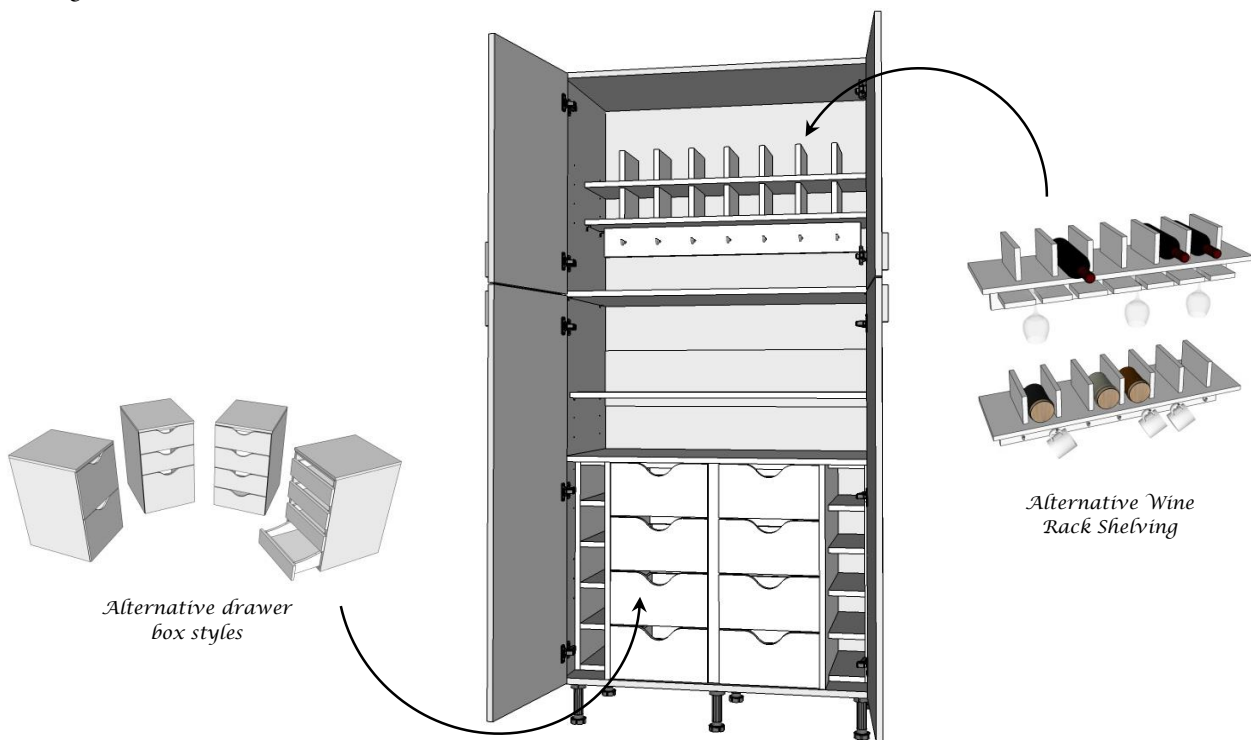

800, 1000 & 1200mm wide modular units - Flat Pack Larder Housing:

Modular units 800, 1000 & 1200mm wide are supplied flatpacked. The fitter must first build the housing BEFORE filling the cabinet with the internal fitments. Refer to the Flat Pack larder Instructions in order to assemble the housing.

Note: ALL internal fitments are supplied **FULLY ASSEMBLED** ready for fitting.

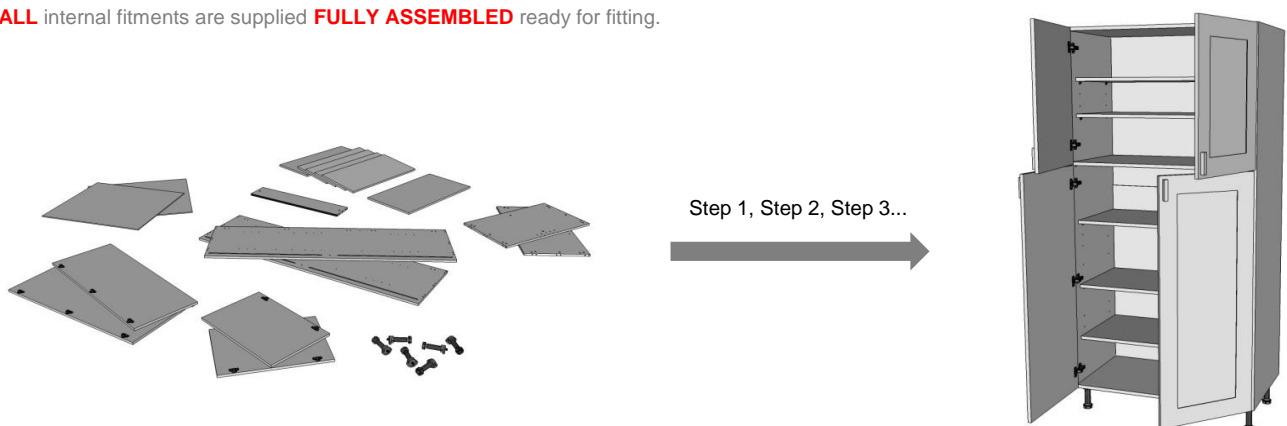

Generic Product Specification - Modular Units - Fitting method 2

Important Information: The following fit shows how to position & fix all internal fitments into the modular unit.

MASTERCLASS®
KITCHENS

The Modular Unit Fitting Process:

Step 1 - Fitting x2 150mm Box Wine Racks & x2 Drawer boxes:

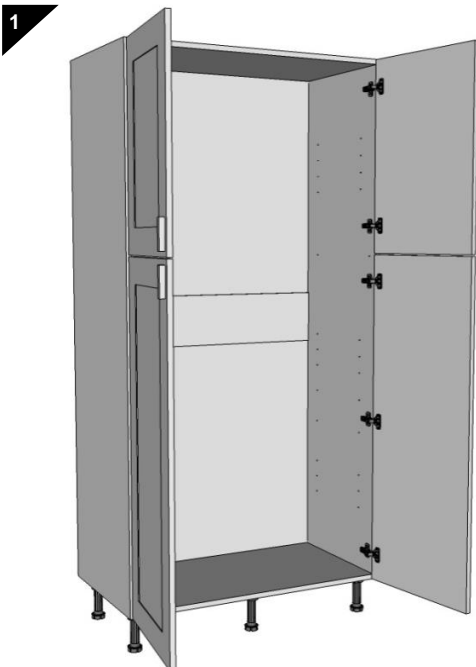
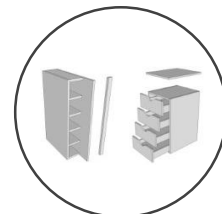

Begin with the larder housing:

- Ensure larder is ready for the internal fitments by removing all x6 shelves.
- Doors must be adjusted / levelled correctly prior to fixing the internal fitments.

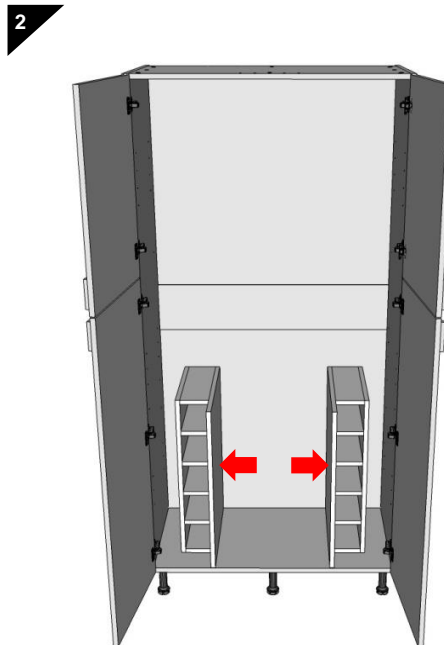

Insert 150mm box wine racks into housing:

- Begin by inserting the 150mm box wine racks inside the cabinet.

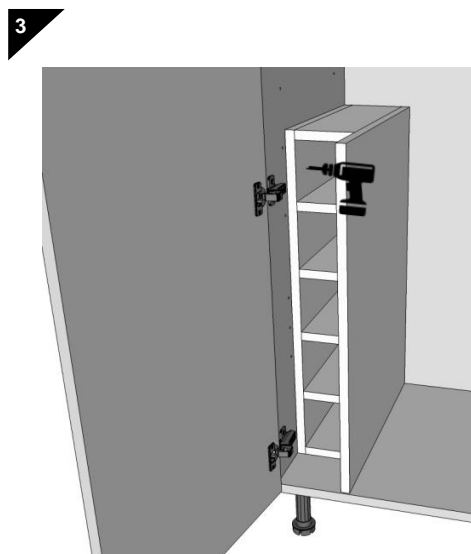

Fix with screws into the side cheek:

- Place the 150mm Box Wine Rack against the cabinet side cheek. Fix with screws from within the box wine rack.

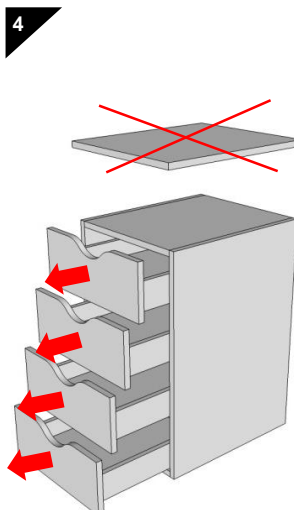

Note:

- For this modular unit configuration, the loose shelf supplied per drawer box is not needed.

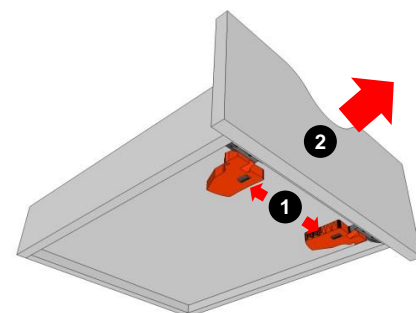

Remove the drawers from both drawer boxes:

- Place hands under the drawer box & grip the Movoento locking mechanism (1) & pull towards the edges of the drawer. This will release the drawer from the runners.
- Pull the drawer away from its runners to successfully remove the drawer.

The Modular Unit Fitting Process:

5

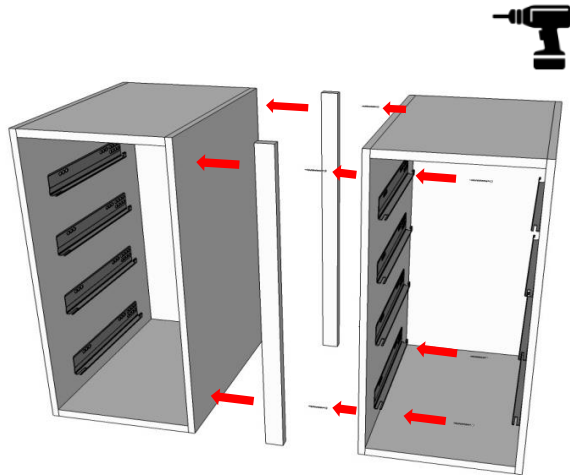

Assemble the x2 drawer boxes & x2 spacers:

- Place the x2 spacers towards the front & back in between the drawer boxes. Use 3/4 8 screws to fix both drawer boxes & spacers together.

6

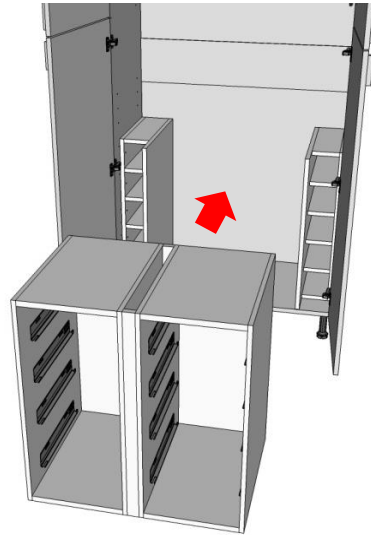

Insert assembled drawer boxes with spacers into housing:

- Insert the assembled drawer boxes & spacers between the x2 fitted 150mm box wine racks. The drawer boxes will slide in between the 150mm box wine racks.

7

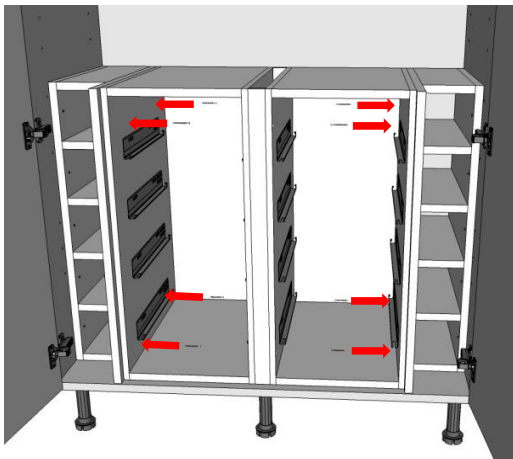

Fix the drawer boxes with assembled spacers into the 150mm box wine rack:

- Use 3/4 8 screws to fix into the 150mm box wine racks.



8

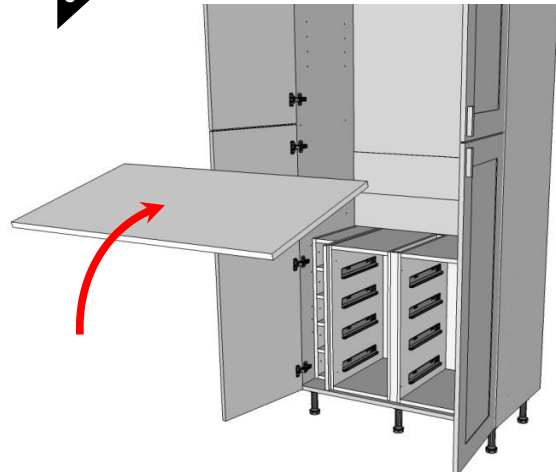

Insert the full depth shelf into the cabinet housing:

- Place the shelf on top of the drawer boxes & 150mm box wine rack. No shelf pegs are required.

Generic Product Specification - Modular Units - Fitting method 2

Important Information: The following fit shows how to position & fix all internal fitments into the modular unit.

MASTERCLASS®
KITCHENS

The Modular Unit Fitting Process:

9

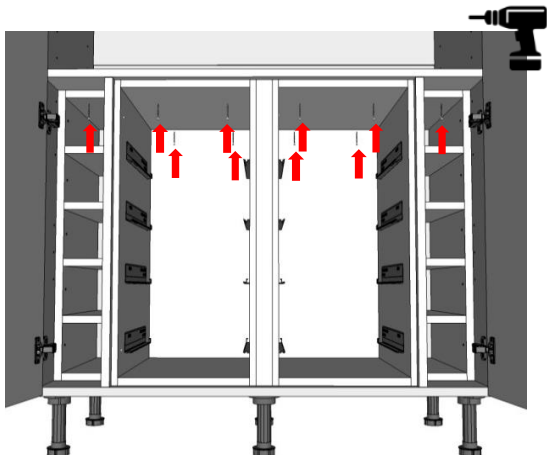

Fix the shelf from the underside of the drawer box & 150mm box wine racks:

- Use 3/4 8 screws to fix the shelf into position. **Note: ENSURE** shelf is pushed to the back of the cabinet before fixing.

10

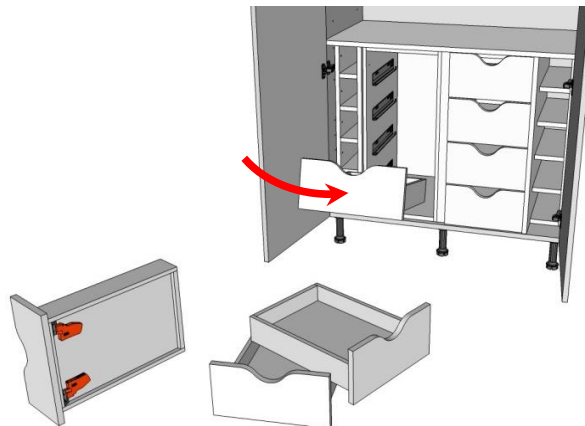

Insert drawers into the drawer box:

- All fixings for the lower level of the modular unit are now complete. The fitter can now reinsert the drawers into the housing.

Step 1 completed. Next Step - Fitting the Loose Shelves

Step 2 - Fitting the Loose Shelves

11

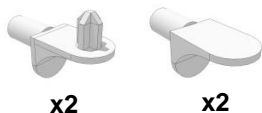
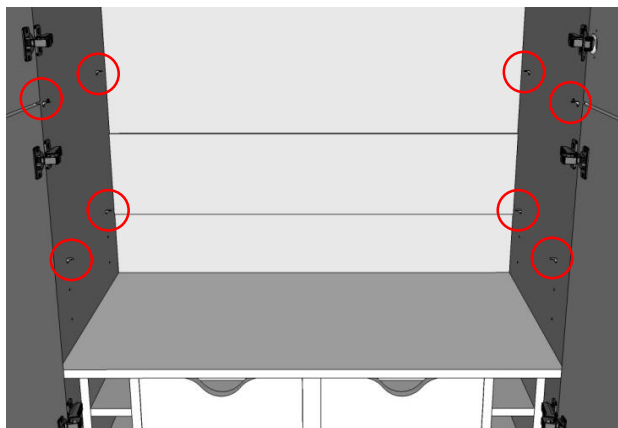

Full depth shelf:

- Use the following shelf pegs for the full depth shelf - the metal lug shelf pegs (Spike) are intended for the front of the cabinet.



Reduced shelf:

- Use the following shelf pegs for the reduced shelf.

12

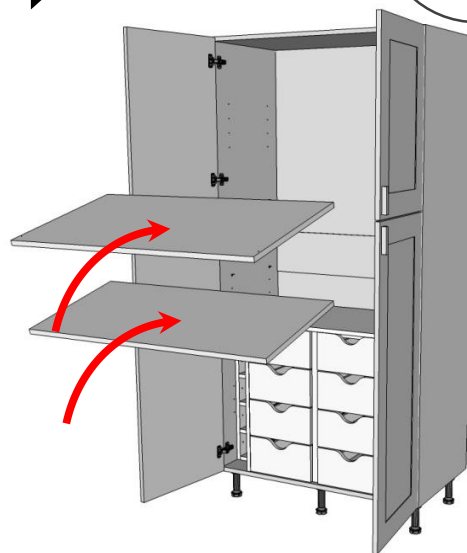

Insert the shelves into the cabinet:

- Position the shelves on top of the shelf pegs. Ensure shelves are pushed to the back of the cabinet.

Step 2 completed. Next Step - Fitting the Wine Rack Shelf with Cup Holders

The Modular Unit Fitting Process:

Step 3 - Fitting the Wine Rack shelf with Cup Holders:

13

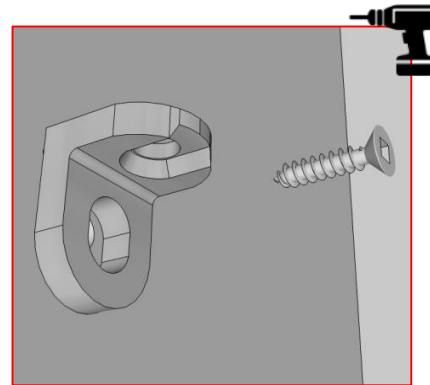
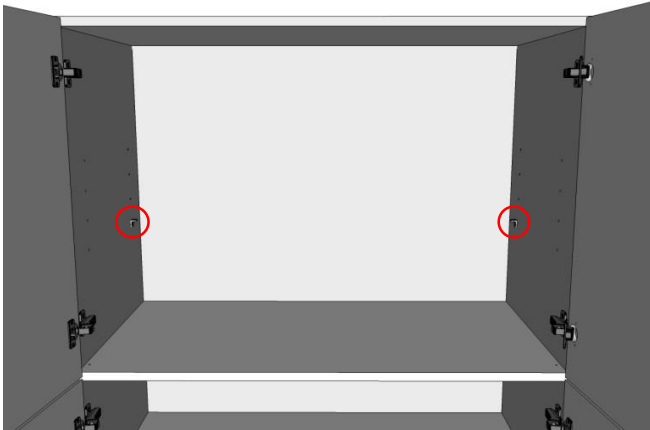

Begin by inserting x2 L tags into any back x2 shelf holes:

- Place the x2 shelf L tags into position. The back L tags must be fitted to allow a surface for the wine rack shelf with cup holders.

14

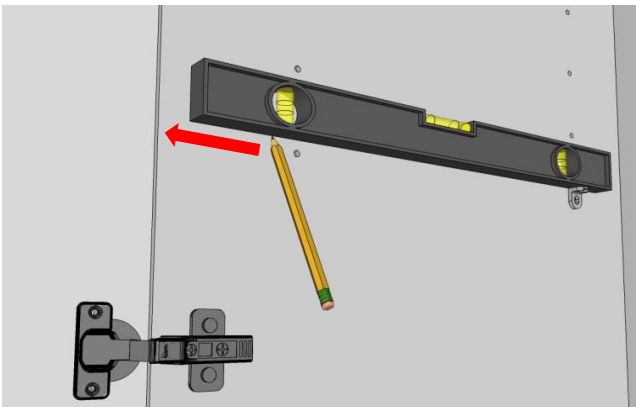

Measure The level & mark for the next set of L tags:

- Use a spirit level on top of the back x2 L tags fitted.
- Ensure the spirit level is level.
- Using a pencil, mark an accurate guide line for the wine rack shelf with cup holders.
- The second set of L tags will be fitted to the wine rack shelf.

15

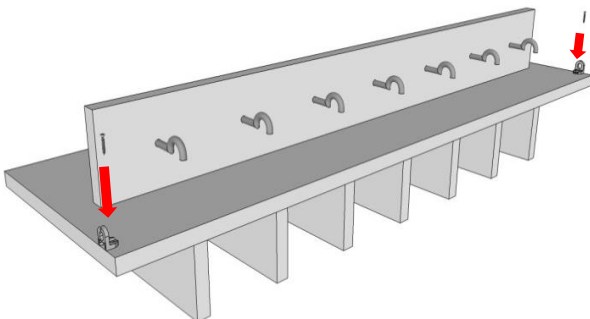

Refer to the wine rack shelf with cup holders - turn over & fix L tags:

- Turn the wine rack shelf with cup holders onto its underside.
- Fix the L tags near the FRONT of the cup holders section.
- The fitter can position these L tags anywhere, but not on the edge. Allow a purpose step back.

16

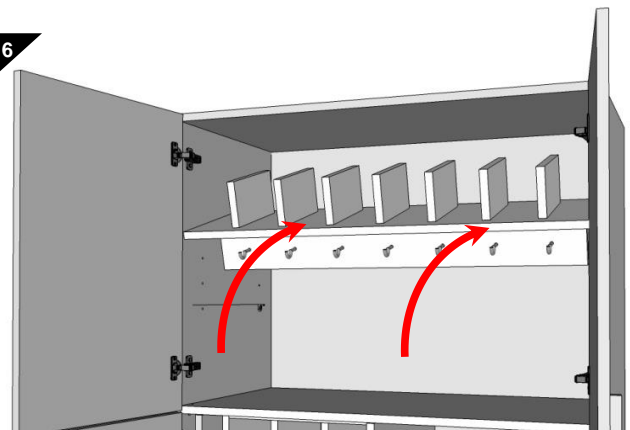

Place the wine rack shelf with cup holders into the modular unit:

- Insert the wine rack shelf with cup holders into the cabinet.
- Place the back of the wine rack shelf onto the fitted L tags fitted earlier.

Generic Product Specification - Modular Units - Fitting method 2

Important Information: The following fit shows how to position & fix all internal fitments into the modular unit.

MASTERCLASS®
KITCHENS

The Modular Unit Fitting Process:

17

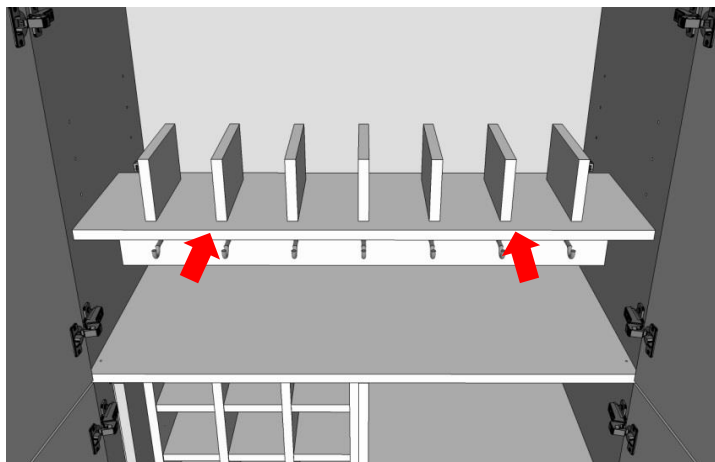

Ensure the wine rack shelf with cup holders is pushed to the back of the cabinet:

- Slide the wine rack shelf with cup holders to the back of the cabinet.

18

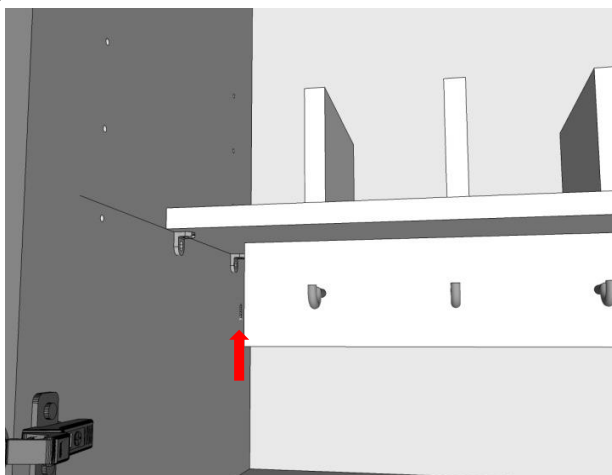

Fix the BACK L tags into the Wine rack shelf with cup holders:

- The wine rack shelf with cup holders should be in line with the pencil guide line.
- Fix the **BACK** x2 L tags into the wine rack shelf.

19

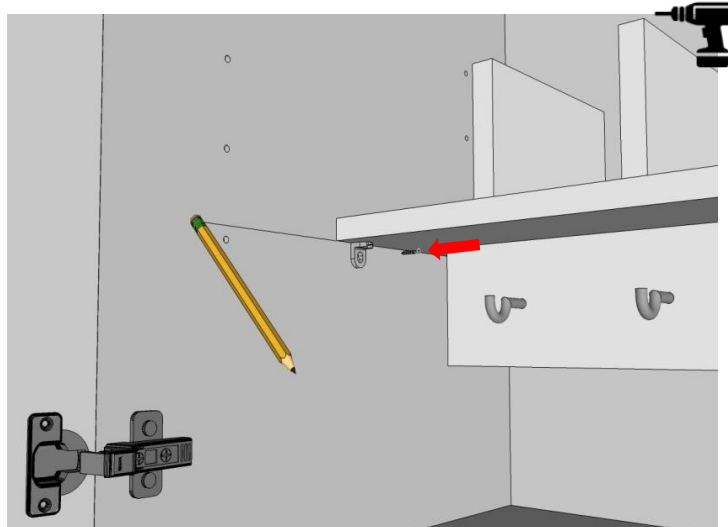

Fix the FRONT L tags into the Cabinet side cheeks & erase pencil line:

- Apply screws & fix the FRONT L tag into the cabinet side cheeks.
- Erase the pencil guide line as the fit is now completed.

Step 3 completed. Next Step - Fitting the Wine Rack shelf

The Modular Unit Fitting Process:

Step 4 - Fitting the Wine Rack shelf

20

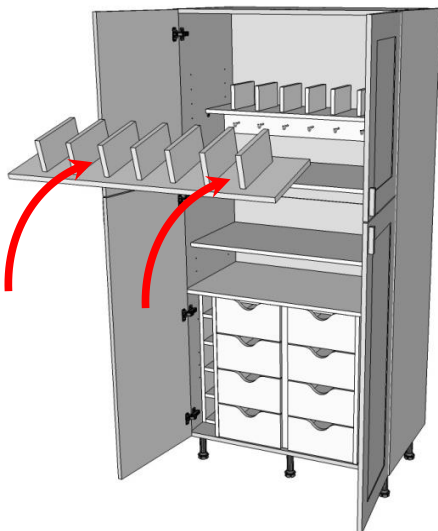

Place the wine rack shelf on top of the wine rack shelf with cup holders:

- ENSURE wine rack shelf is pushed to the back of the cabinet.
- This shelf is designed to simply 'sit' on top of the wine rack shelf with cup holders.

21

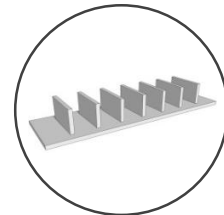
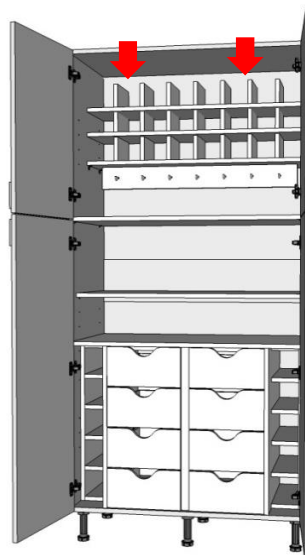

OPTIONAL - additional wine rack shelving:

- The fitter can add further wine rack shelving if desired.
- Note: The more wine rack shelves used, the more securing is required. Use L tags for the top wine rack shelf.

Step 4 completed. Next Step - Modular Unit Fit Complete

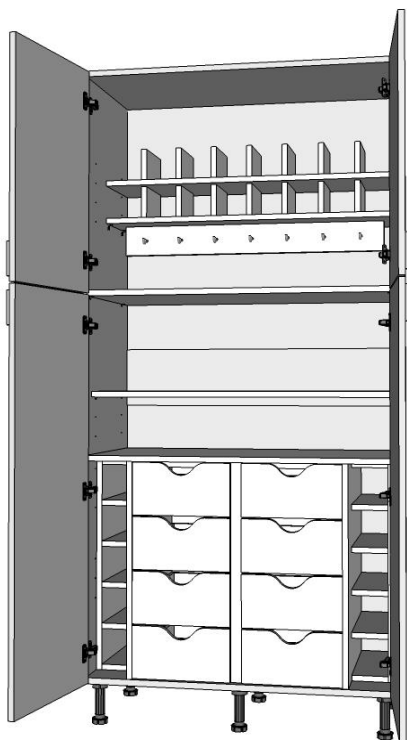

Symbol used in fit:



Drill - Icon refers to parts that can be drilled to fit together.