

The Lansbury

60CL19/21 Assembly Instructions

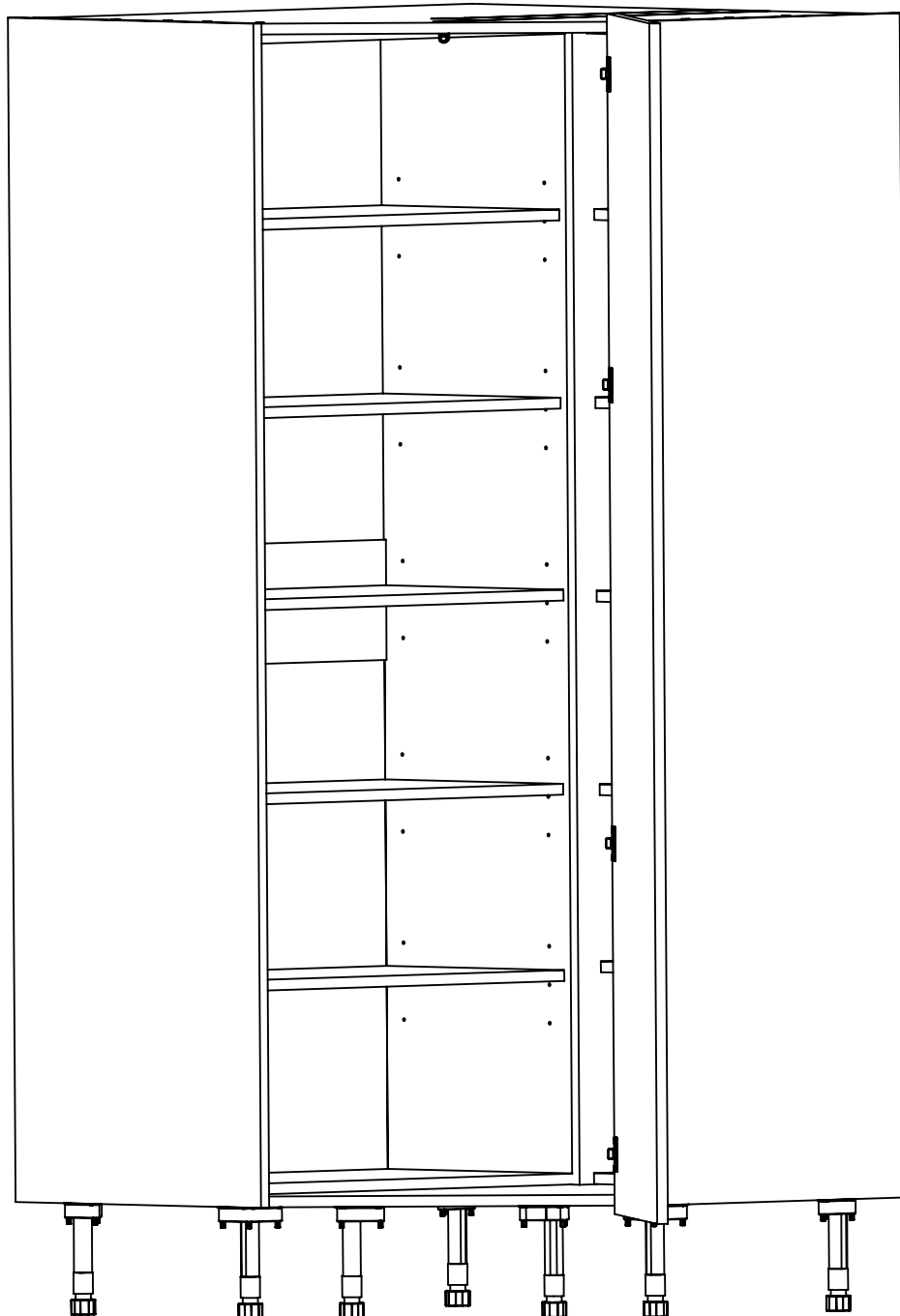

Scan for electronic copy.

The following document will provide you with the necessary information to assemble the 'Lansbury' corner larder unit.

Contents:-

Introduction	2
Safety Notice	2
Tools Required	2
Components Supplied	3
Assembly	4
Base Panel	5
Large Inner Unit	6-7
Small Inner Unit	8-9
Main Body	10-11
Top Panel	12
Shelving	13
Door Fitting	14-15

Introduction:

The Masterclass Tall Corner Larder unit is an extensive & flexible storage system designed for the corner of the room. The unit is available to order in two heights - 1970mm (CL19) & 2150mm (CL21).

This unit is designed in one overall width & depth at 1043 x 1043mm.

The following pages will show important points to be aware of when planning this unit, followed by fitting instructions to help assemble the tall corner larder.

The Lansbury is fitted with an LED spot light complete with PIR sensor and driver as standard. Please ensure there is a suitable mains (240v) power supply available for the installation.

Please be aware this unit is supplied flat packed. Please ensure that you have prepared an area large enough for the assembly process.

Safety Notice:

Be aware that assembled units can be heavy. We recommend two person handling during assembly of this product.

Due to the size of the completed units it is suggested that it is assembled in an area as close as possible to the final installation location.

Ensure the intended assembly area is clear of trip hazards and that pets and young children are at a safe distance.

During assembly use a soft object such as a blanket to rest panels on to prevent damage to the show surfaces.

Tools Required:

Tape Measure
Hammer
Spirit Level
Screwdrivers

Components Supplied:

Each unit will be supplied with the necessary fixings and fasteners to fully assembly the unit.
Please check you have the required quantity before proceeding with the assembly.

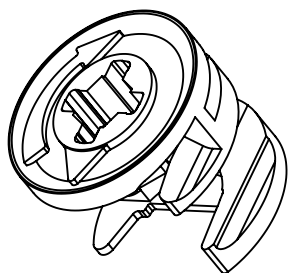

Cam x 20

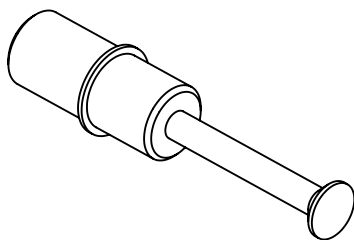

Cam Bolt x 20

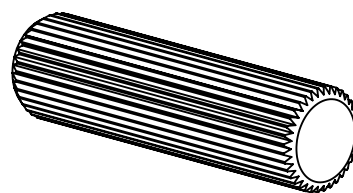

Dowel x 12

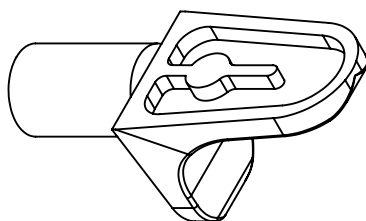

Shelf Peg x 20

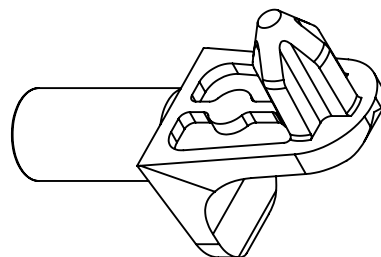

Spiked Shelf Peg x 20



Hi-Lo Screw x 4



LED Spotlight,
driver and PIR
sensor x 1

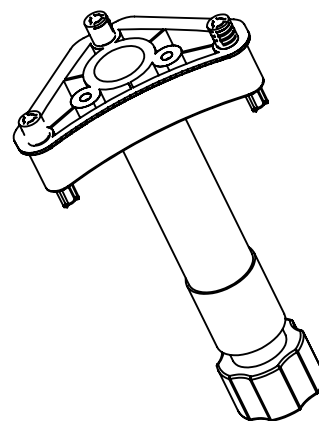

Leg Socket &
Adjustable leg x 7

Assembly Examples & Tips

Insert dowels into the same side as the cam.



Insert cam bolts into the side opposite the cam.

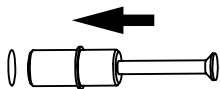

This is a close up of the cam. Note the position of the pointer. It needs to be pointing towards the cam bolt when fitting. To lock into place turn clockwise in the direction of the arrow.

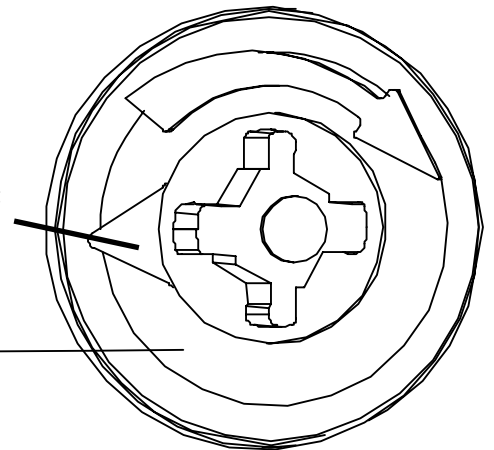

Insert cam with arrow pointing towards edge.

To make assembly easier it is good practice to fit the cams, cam bolts and dowels in the correct positions before assembly to ensure they are in the correct positions.

Assembly

Step 1- Base Unit:



Prepare a flat area large enough for the base panel to be laid flat. Protect the surface with a blanket.

Lay the panel down with the leg locating holes visible as shown below. The leg locating holes are circled - each leg uses 3 holes when fitted.

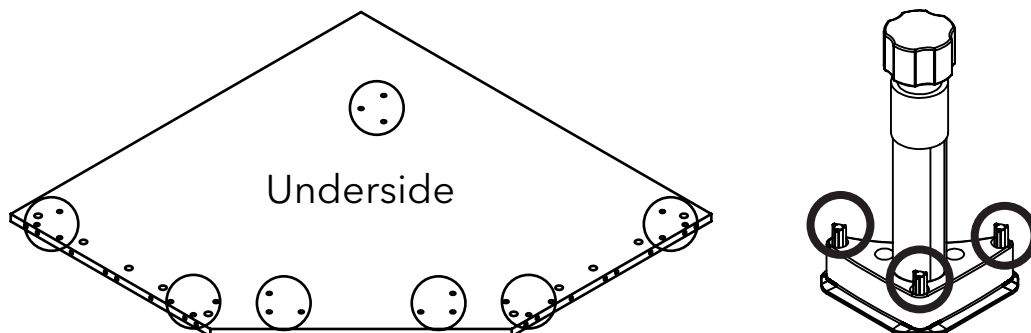

One at a time, align each of the leg sockets with the corresponding 3 holes on the base panel. Tap the socket into place between the 3 locating pins until there is no gap between the base panel and the leg socket. Use a hammer and tap each of the locating pins down until they no longer protrude up from the leg socket. Once all 3 are fully located the leg socket should be fully secure. NOTE: There should be no gap between the black plastic leg base and the panel. When the sockets are all in place the legs can be pushed into place.

When all 7 feet are fitted, the base assembly should appear as the image opposite.

At this point install the cams and dowels before turning over.

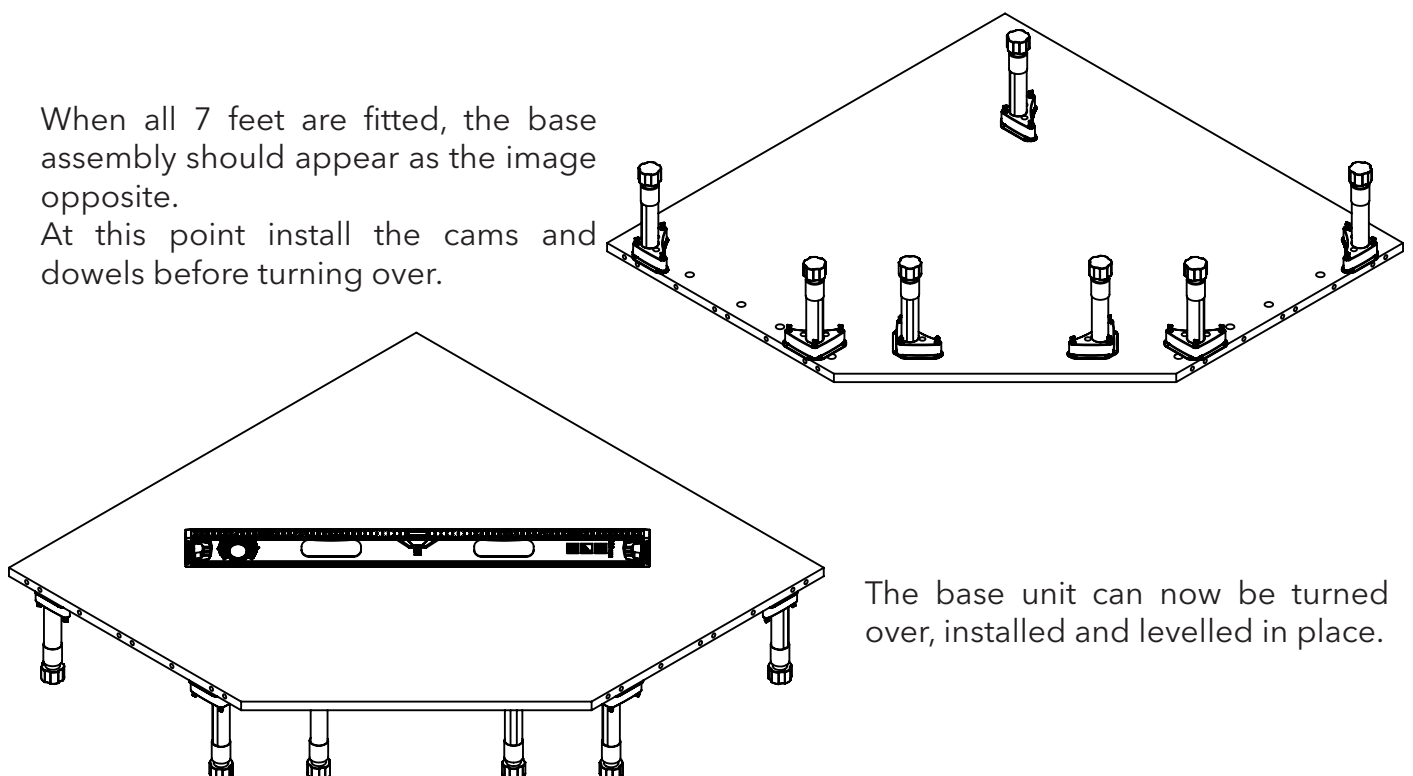

The base unit can now be turned over, installed and levelled in place.

Step 2- Large Inner Unit:

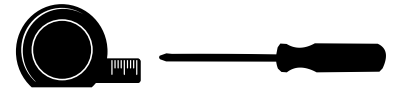

The large inner unit consists of 2 sides, a top and bottom, 5 internal shelves, back brace and back panels.

Dowels, cams and cam bolts will be required to assemble the main units. The shelves can be installed later.

At this stage the fitter should decide if the larger of the units is to be fitted to the left or right side and check the order to see which side the door will be opened from as one of the 1970x600mm panels will have the hinge holes pre-drilled along the front edge.

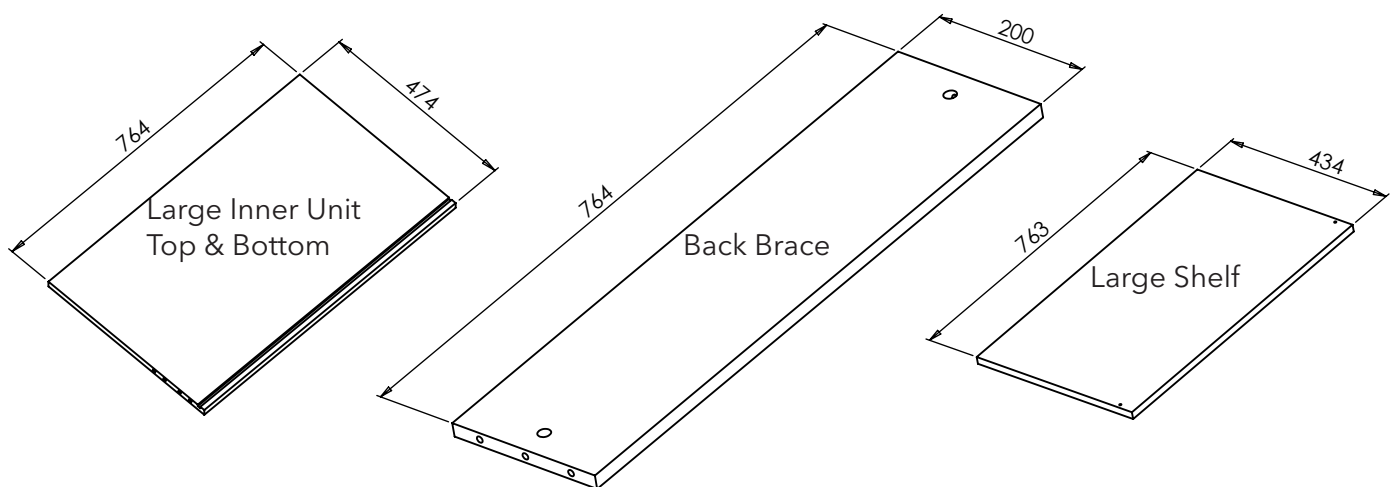
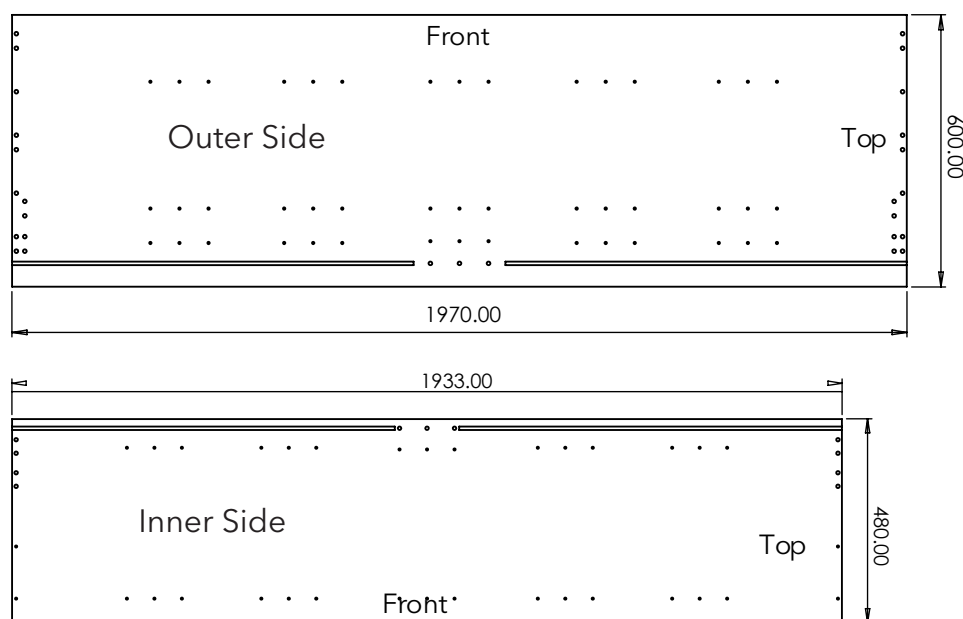

(These are the main components required for the assembly of the unit.)

Assembly

Step 2 - Continued:

You will need the following parts:-

Outer side, top & bottom and back brace & large inner side.

Dowels, cams and cam bolts.



Lay the outer side panel on a flat surface taking care not to damage the underside.
Insert cam bolts and dowels in the correct holes which correspond with the parts to be fitted.

Using cams and dowels, guide and lock the top, bottom and back brace into place.

The 8mm back panels simply slide into the pre-cut recesses in the panels.

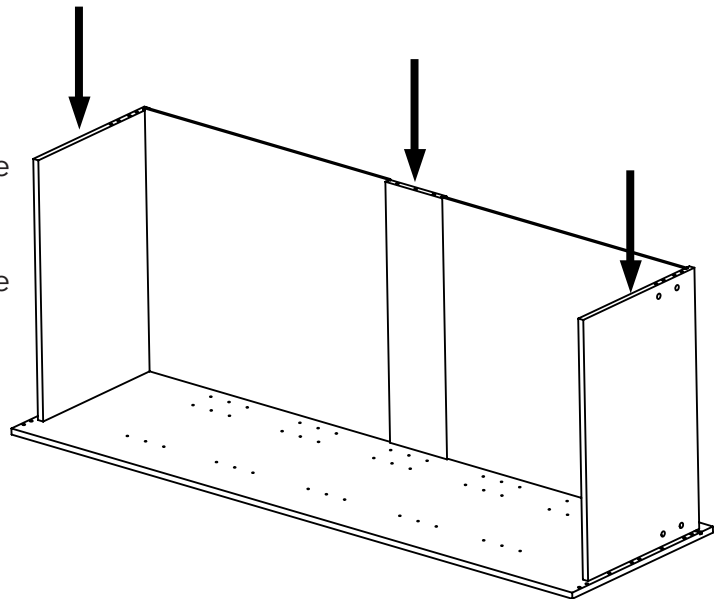

Insert the cams and dowels into the newly fitted top, bottom and back brace. The right side will require cam bolts to match. Locate the right side of the unit. Tighten the cams to secure.

Use 4 x Hi-Lo screws (supplied) and fix the side using the pre-drilled as shown opposite.

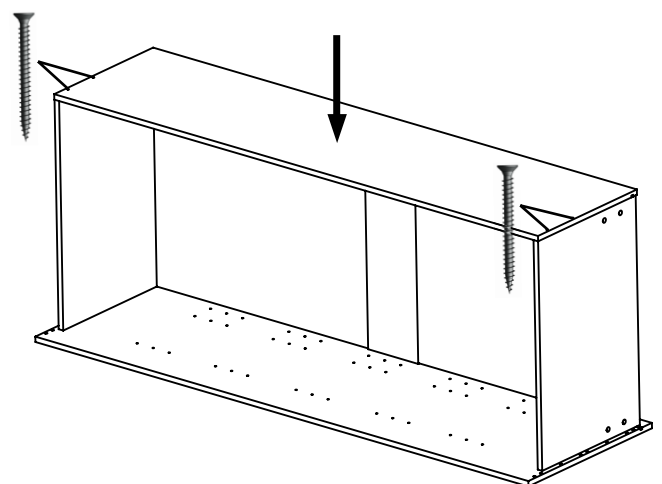

The unit can be carefully placed aside until the next process is completed.

Step 3 - Small Inner Unit:

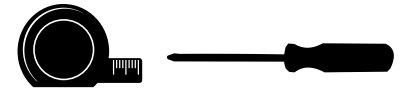

The small inner unit consists of 2 sides, a top and bottom, 5 internal shelves, back brace and back covers.

Dowels, cams and cam bolts will be required to assemble the main units. The shelves can be installed later.

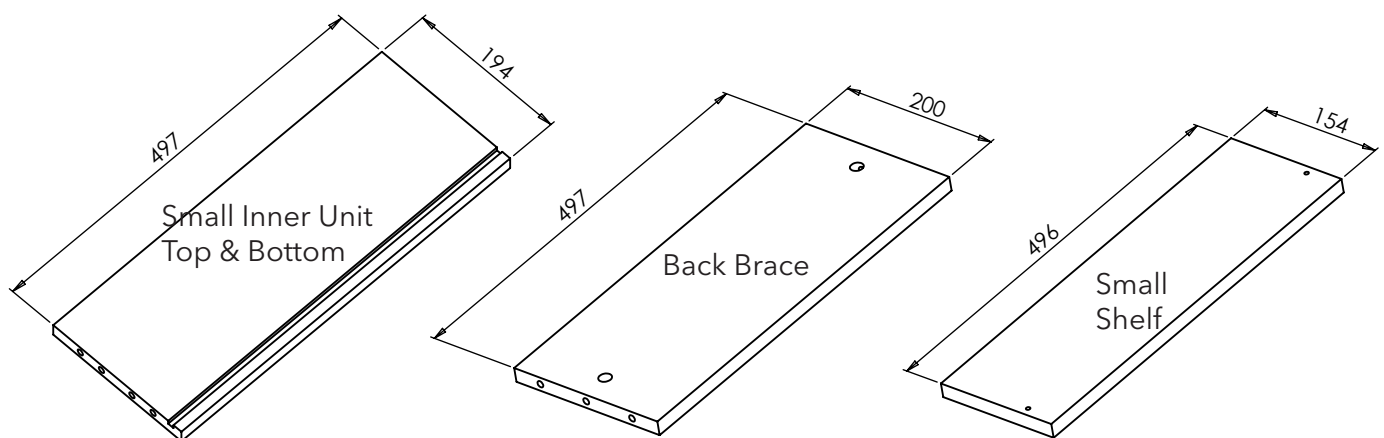
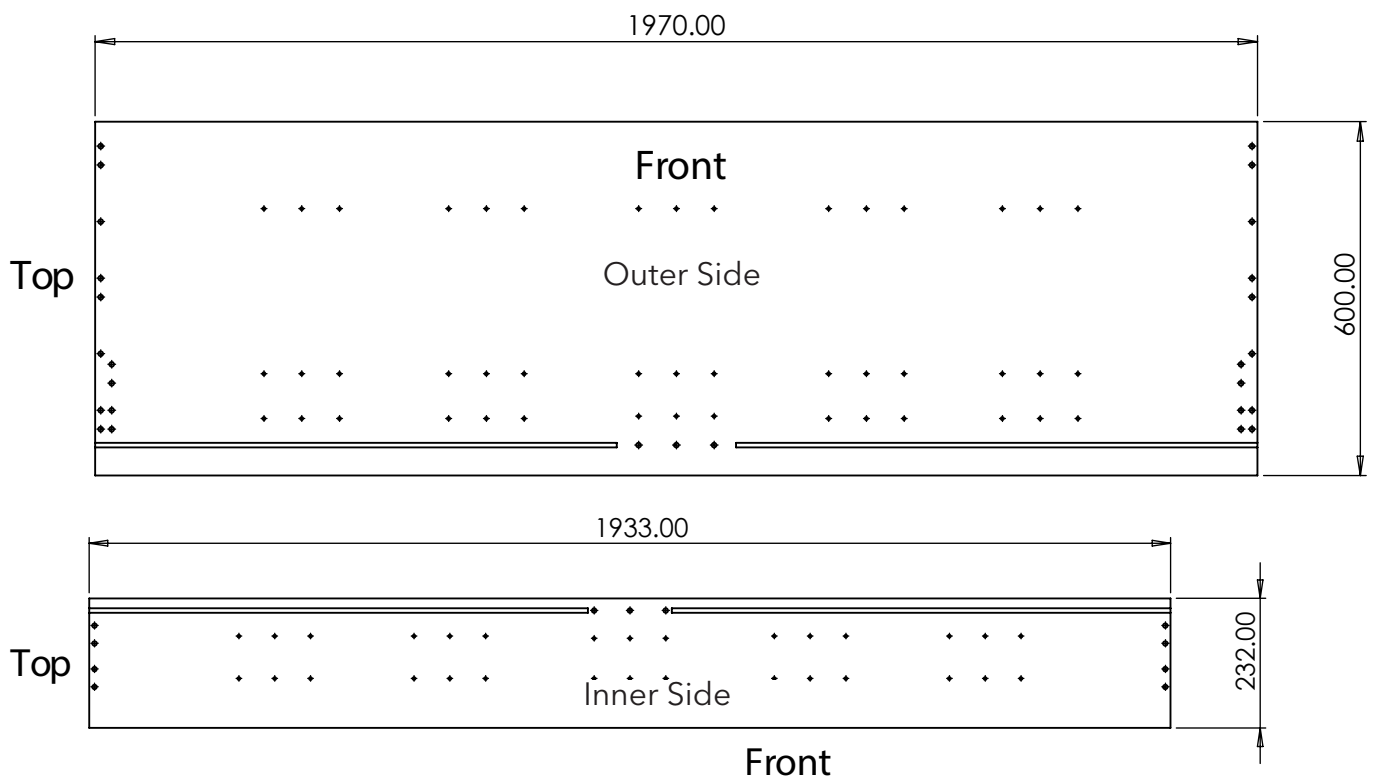

(These are the main components required for the assembly of the unit.)

Assembly

Step 3 - Continued:

You will need the following parts:-

Outer side, top & bottom and back brace & small inner side.

Dowels, cams and cam bolts.



Lay the outer side panel on a flat surface taking care not to damage the underside.
Insert cam bolts and dowels in the correct holes which correspond with the parts to be fitted.

Using cams and dowels, guide and lock the top, bottom and back brace into place.

The 8mm back panels simply slide into the pre-cut recesses in the panels.

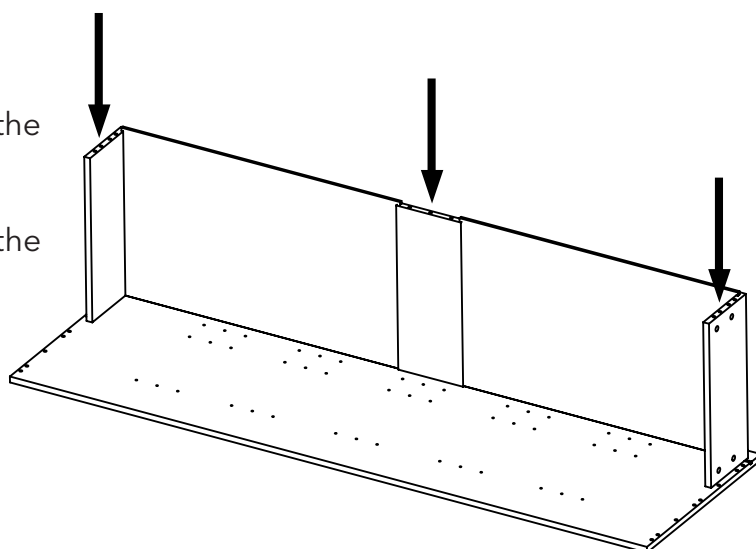

Insert the cams and dowels into the newly fitted top, bottom and back brace. The inner side will require cam bolts to match. Locate the inner side of the unit. Tighten the cams to secure.

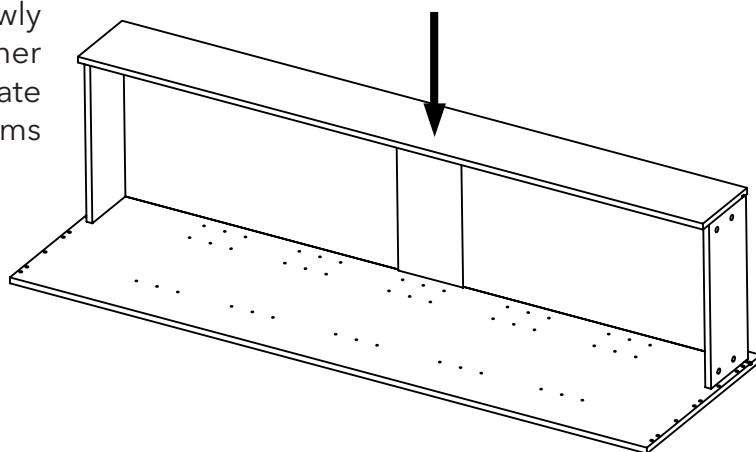

The unit can be carefully placed aside.

Step 4 - Main Body Assembly:

You will need the following parts:-

Base Sub-Assembly

Large Inner Unit Sub-Assembly

Dowels, cams and cam bolts.



It is strongly recommended that 2 persons undertake the next part(s) of the assembly process.

Firstly, fit the cam bolts to the bottom inner edge of the large unit (circled opposite).

Carefully place the unit onto the base (1) and locate the cam bolts and dowels into the side edge of the base unit (2).

Tighten the cams from the underside of the base unit.

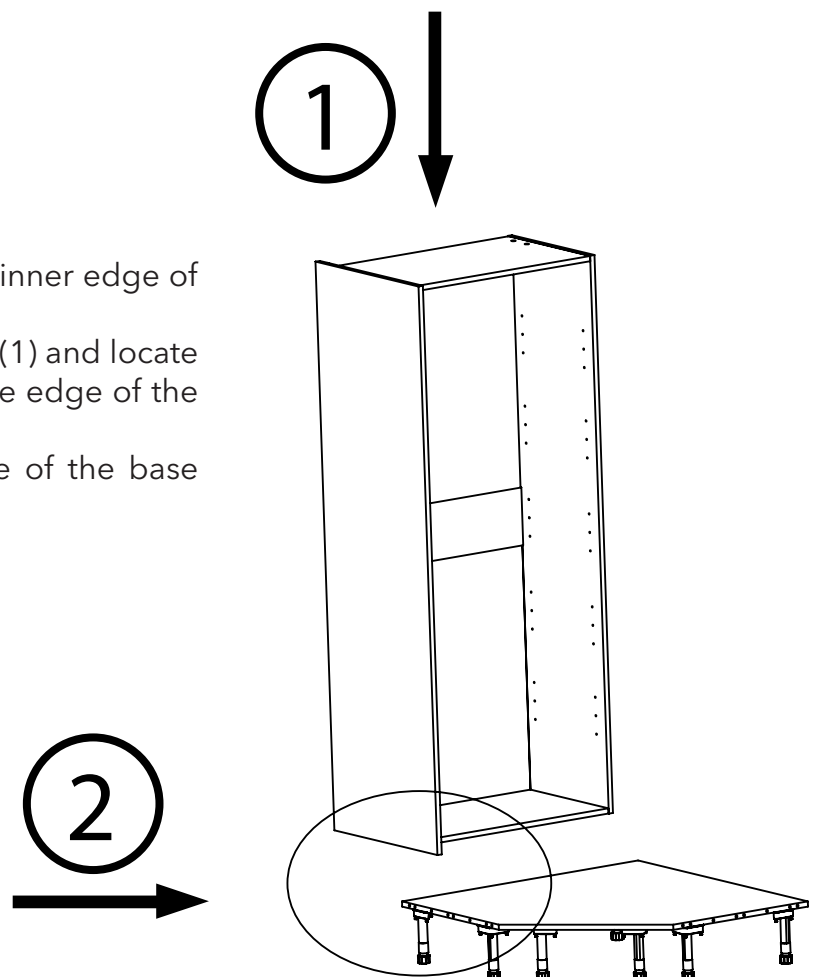

IMPORTANT!

Check that the outer panels, sides & base panels are pulled tightly together by the cams on ALL assembled units.

This will ensure structural integrity of the overall finished unit.

Assembly

Step 5 - Fitting Top Assembly:

You will need the following parts:-
Base & Large Inner Unit Sub-Assembly.
Top Assembly.
LED system.
Dowels, cams and cam bolts.



The LED is simply push fit into the pre-cut hole. The PIR sensor is screwed into position using the pre-cut hole and supplied screws. All cables will run along the recesses on the top of the unit. Refer to the manufacturers instructions for further information.

It is strongly recommended that 2 persons undertake the next part(s) of the assembly process.

Check your parts to make sure the cams, cam bolts & dowels are in the correct positions as shown below.

Lower the top onto the large inner assembly, making sure the LED is facing down. Carefully slide the top onto the cam bolts - the dowels should also align with the receiving holes.

Tighten the 5 x cams to secure the top.

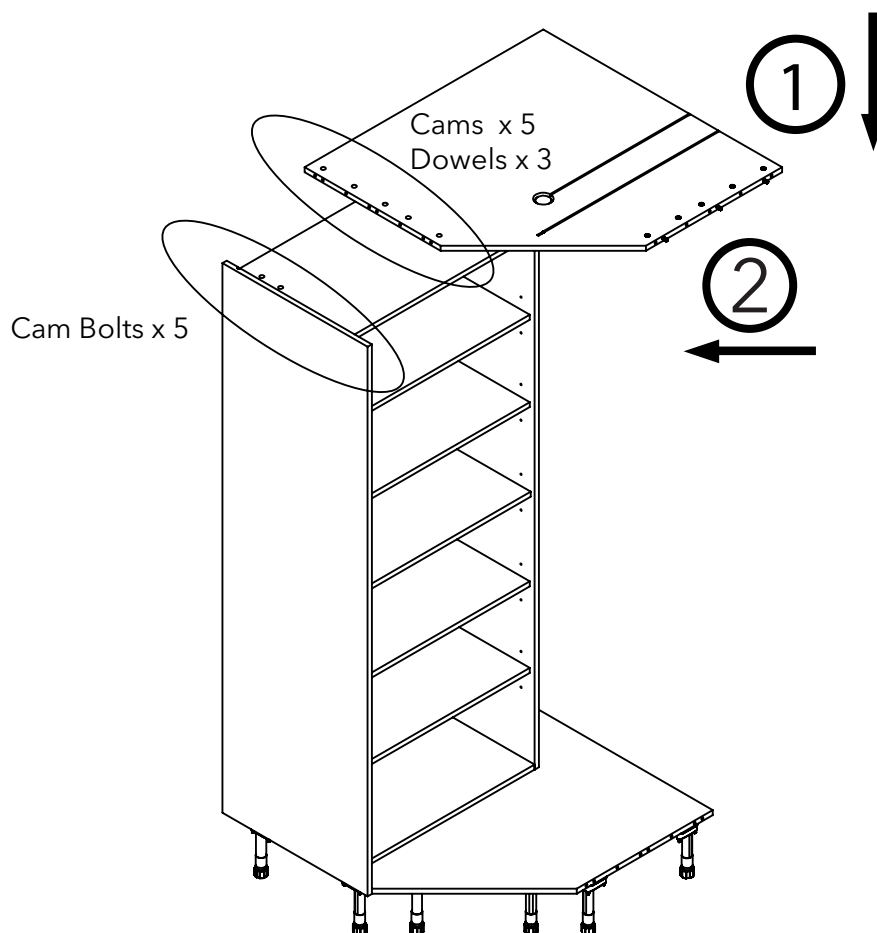

Step 6 - Fitting Small Inner Assembly:

You will need the following parts:-

Assembly of base, large inner and top.

Small Inner Assembly.

Dowels, cams and cam bolts.



Make sure the assemblies have the correct parts pre-fitted as shown below.

Carefully slide the small inner unit in between the top and bottom panels. Align the dowels and cam bolts. Tighten the cams from above and underneath to secure the unit in place.

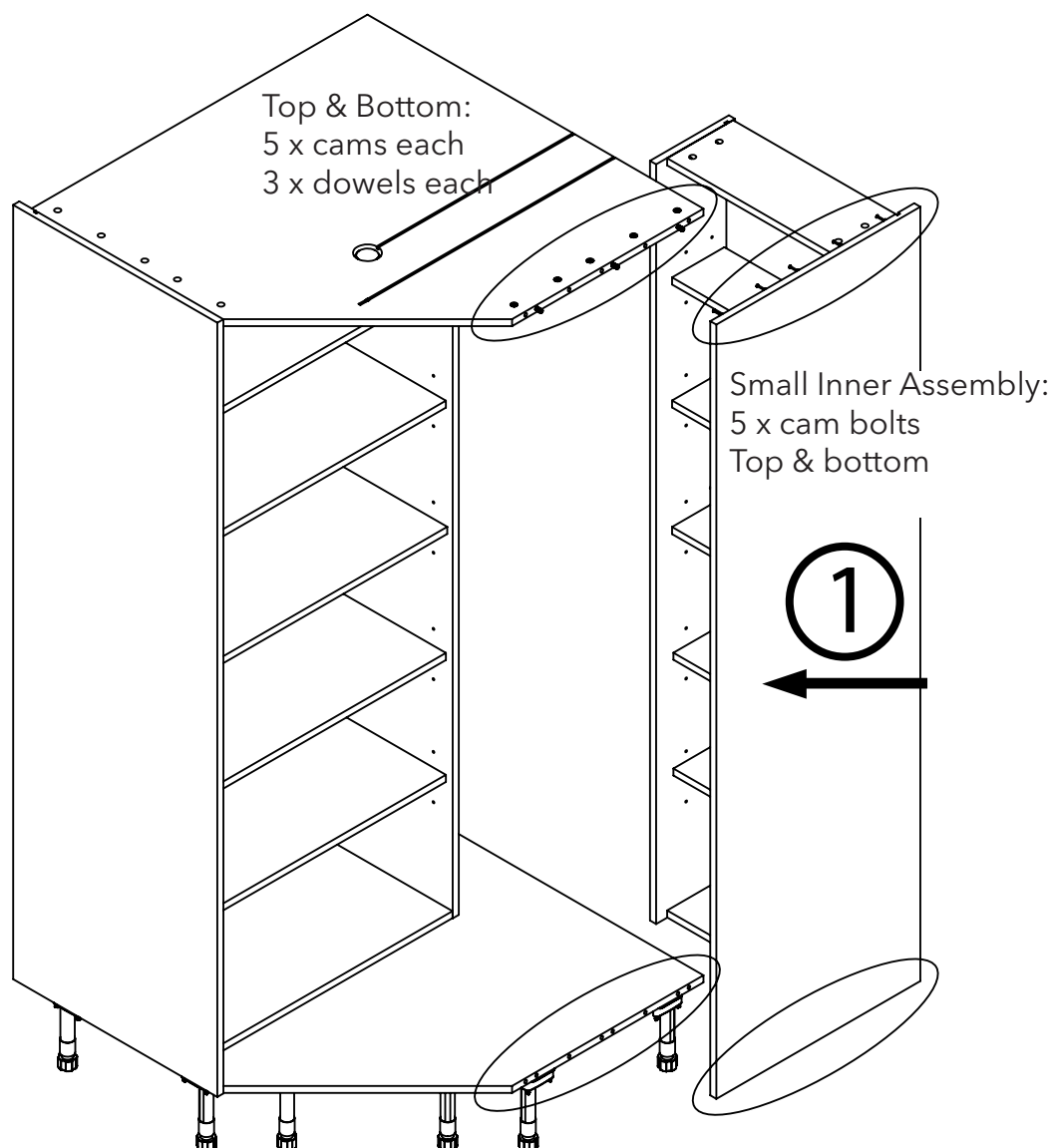

IMPORTANT!

**At this stage, check that the top and bottom cams are fully tightened.
This will ensure structural integrity of the overall finished unit.**

Assembly



Step 7 - Interior Shelving:

You will need the following parts:-

Large shelves x5.

Small shelves x 5.

Standard Shelf pegs x 20.

Spiked Shelf Pegs x 20.

Each unit can be fitted with 5 shelves. For 1 shelf you will need 2 x standard shelf pegs and 2 x spiked shelf pegs. These will need to be fitted as shown in the image below with the spiked peg toward the rear of the cabinet - these are simply push fit. Ensure they are fitted with the shelf support surface / spike in the 'up' position.

Do this for each side of the shelf. Locate the shelf in position with the spiked peg locating in the hole on the underside of the shelf.

Repeat the process for the required number of shelves.

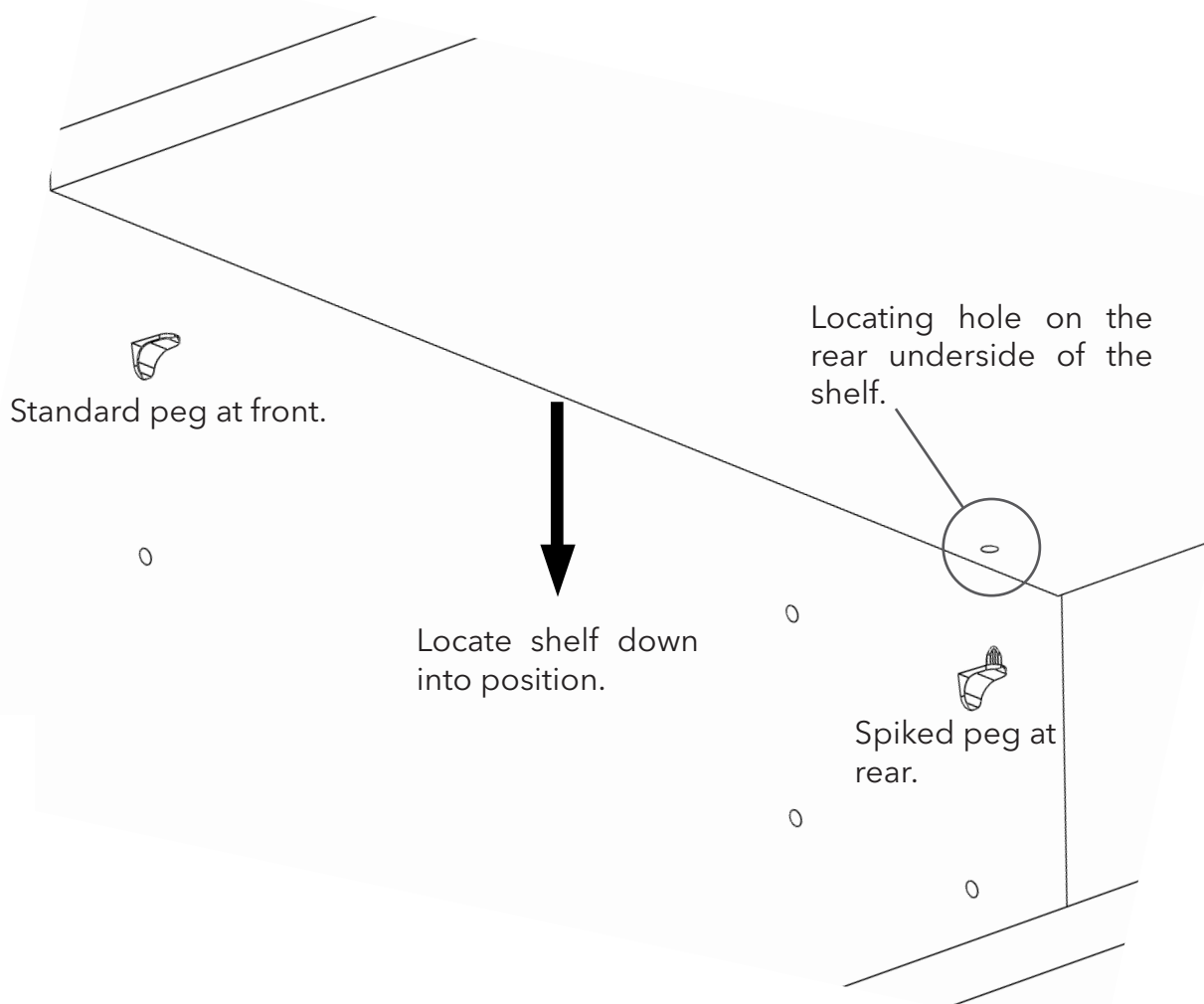

Step 8 - Door Fitting:

You will need the following parts:-

Hinges.

Door(s)



Take the hinge plates and hinges. Fit in the pre-drilled holes in the locations circled below.

Split door units will have an extra hinge - holes will be pre-drilled for this.

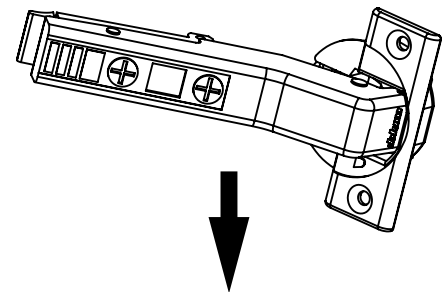
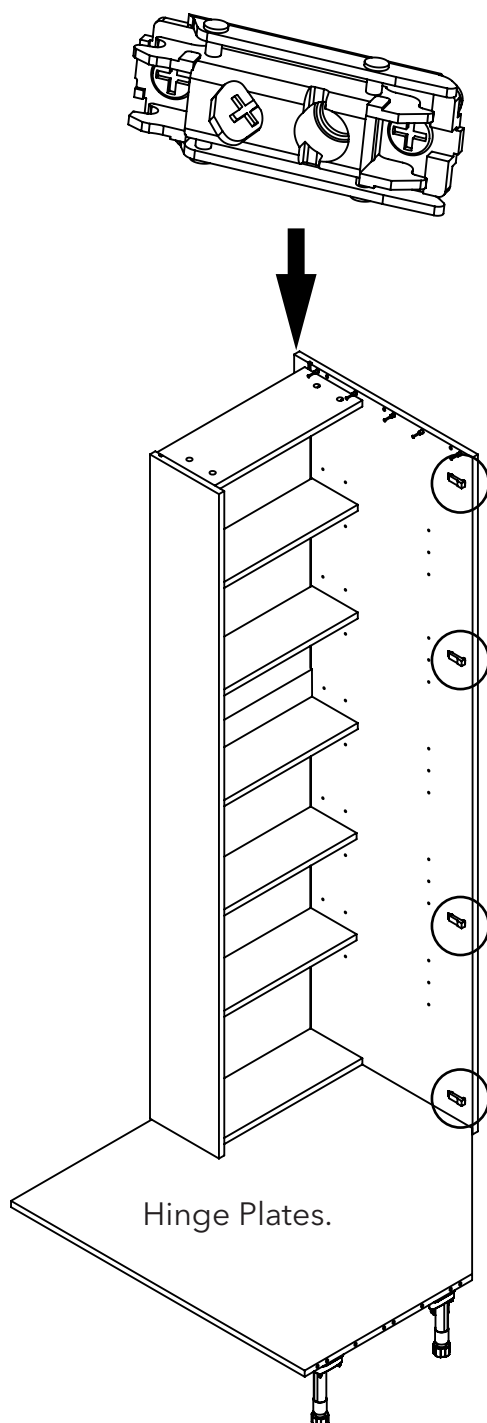

Full height right hand side opening door shown. →

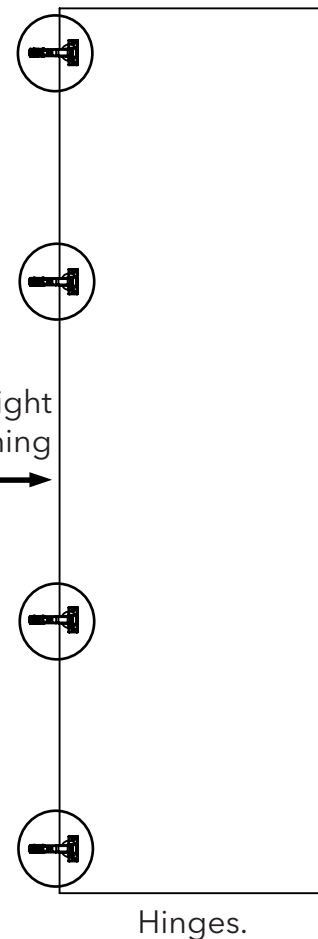

Assembly

Step 8 - Continued:

Once the hinge plates and door hinges are fitted you can finally fit the door to the completed unit.

As shown below, locate the door hinge onto the hooks at the front of the hinge plate and press the rear part of the hinge to lock it into position. You will feel a 'click' when it is correctly positioned.

IMPORTANT: Continue to support the door while fitting the other hinges. Failure to do so will result in damage to the unit and / or hinges.

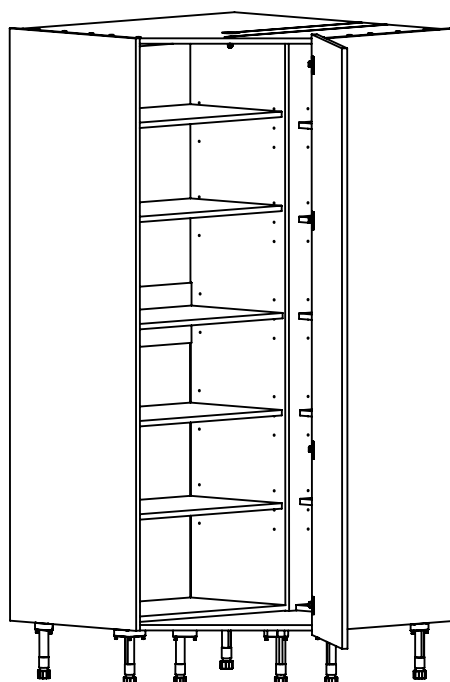
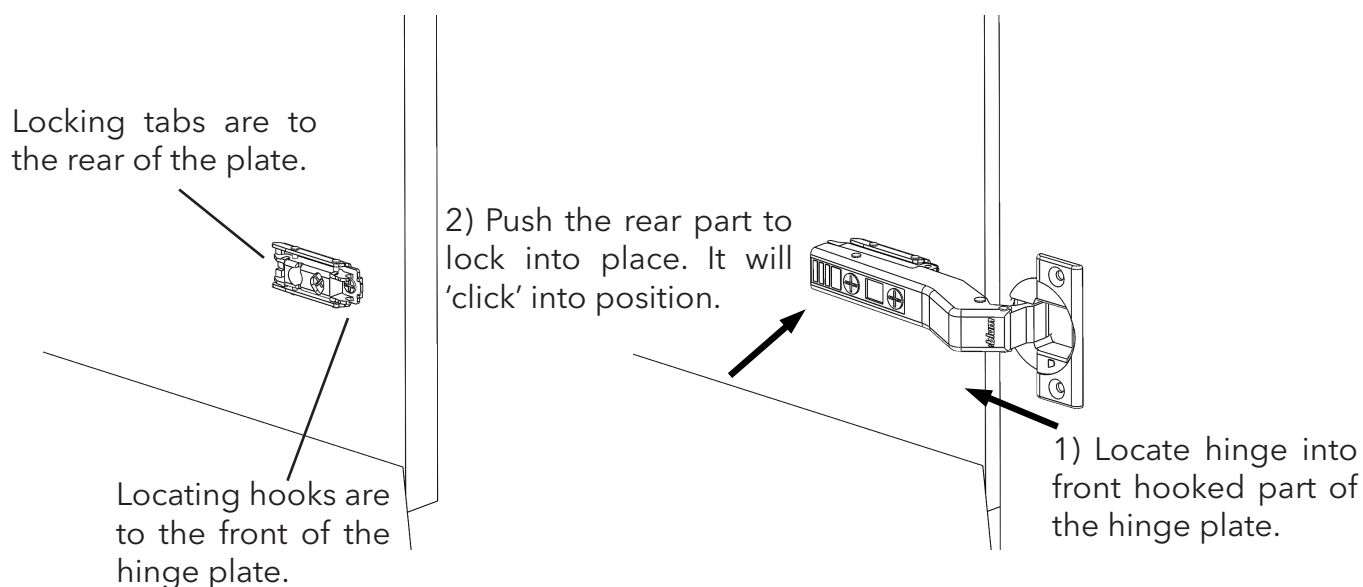

The unit is now complete.